

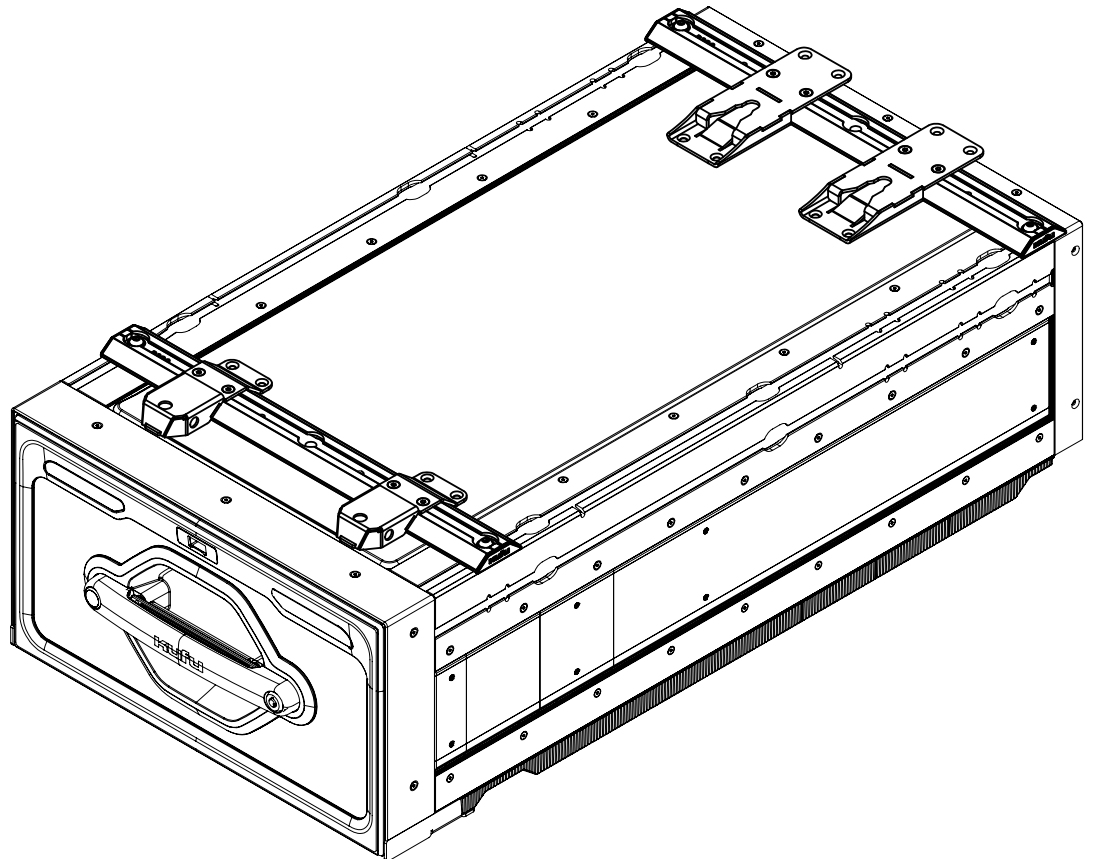

# KUFU System Stacking Kit, with Catch and Click Brackets, Install Guide.

Version: 01

Suitable for:  
KUFU Premium Drawers  
KUFU ECONO Drawers



*Important Information:*

- This Installation Instruction Guide is for the accurate, safe and secure attachment of the Stacking Kit, with Catch and Click Brackets to a KUFU Drawer.
- This install guide shows a 950 KUFU System stack position above a 950 Drawer, other positions are available for the Stacking Kit depending on the Drawer size.
- Longer KUFU System Products cannot be stacked onto shorter drawers beneath.
- Shorter KUFU System Products can be stacked on top of longer KUFU Drawer Systems.
- Open all kits to check that all parts are present.
- Follow all assembly steps in this Instruction Manual.
- Do not skip steps.
- Do not leave out fastener components from the installation steps.
- It is recommended to review the vehicle and crosscheck before making any modifications. Check to avoid damaging critical vehicle components within and beneath the vehicle.
- Always review the installation to ensure parts and assemblies are flat and aligned where possible.
- It is recommended to inform the insurance provider for the vehicle of any modifications and additions or accessories added to the vehicle, these may effect the ability to make claims depending on the level and or type of cover.

**STEP 1 - Installation Preparation:**

- Stacking Kits can be pre-assembled to the Drawer beneath before assembly in to a vehicle.
- Do not attempt to stack KUFU Drawers outside of a vehicle installation.

**STEP 2 - Tools Required:**

- Hex Drive or Allen Key Set
- Socket Set or Spanner Set
- Utility Knife
- Tape Measure

**STEP 3 - Components:**

- Stacking Kit

Part Name	Quantity
B320 Mounting Rail_Install Adaptor_510mm	2
Lock Washer	4
M8 Channel Stud	4
B402 Mounting Rail End Cap_Short	4
M8 x 16mm Button Head Bolt	4
M8 Spring Washer	4
M6 x 20_CTSK_High Tensile 12.9_ZN_BK_DIN7991	8

- B0093 Catch and Click Bracket Kit. Contents per Kit. 1x Kit required per Drawer

Part Name	Quantity
B0092 Click Bracket Assembly	2
B0090 Catch Bracket Assembly	2

- B0093 Fastener Pack - Contents per Kit. 1x Kit required per Drawer

Part Name	Quantity
M6 Nut_Conelock_High Tensile Class 10_ZN_DIN980	22
M6 x 12_CTSK_High Tensile 12.9_ZN_BK_DIN7991	14
M6 x 30_CTSK_High Tensile 12.9_ZN_BK_DIN7991	8

- NOTE: Catch and Click Bracket Kits are packed seperately.
- NOTE: Every KUFU Drawer or Accessory requires a Catch and Click Bracket set to secure the product to the vehicle. KUFU System Products can be attached to a Mounting Platform or Stacked above other KUFU products, make sure you have the required amount of Catch and Click Brackets for your installation.

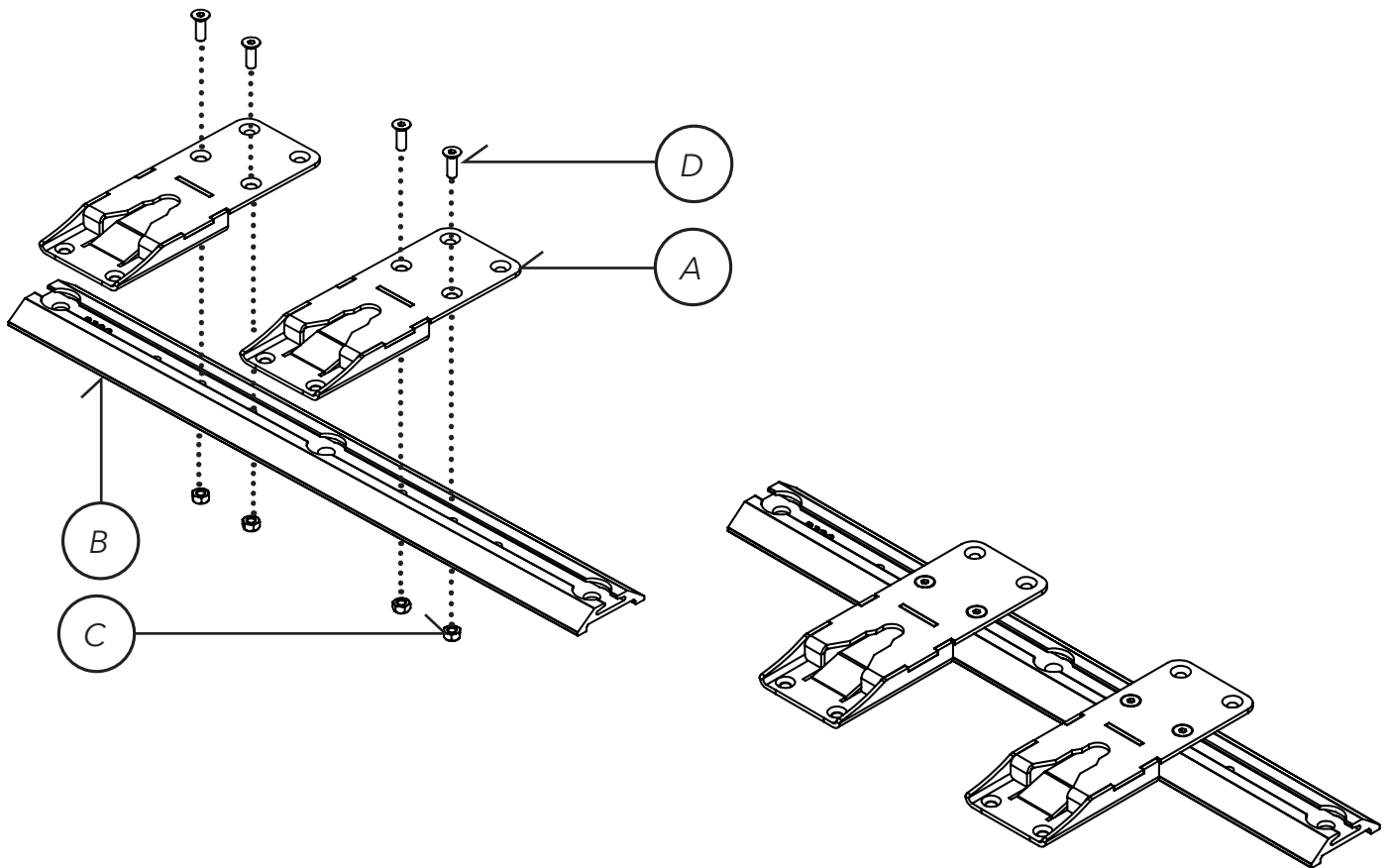

**STEP 4 - Catch Brackets Assembly:**

- Securely Assemble the Catch Brackets to the B320 Rail
- Catch Bracket, Single Assembly shown above in exploded and assembled view.

Part Name	Quantity Required	Item
Catch Bracket, Upper	2	A
B320 Mounting Rail_Install Adaptor_510mm	1	B
M6 Nut_Conelock_High Tensile Class 10_ZN_DIN980	4	C
M6 x 20_CTSK_High Tensile 12.9_ZN_BK_DIN7991	4	D

- Check and ensure all brackets are 90degrees, square to the rail.
- Secure the Catch Bracket Assembly in all positions shown below. Use hand tools to tighten all fasteners. Do not over-tighten fasteners.

NOTE: The Catch Brackets use 2 of 3 holes along the rail in each position, note the remaining holes as a guide of the Catch Bracket positions.

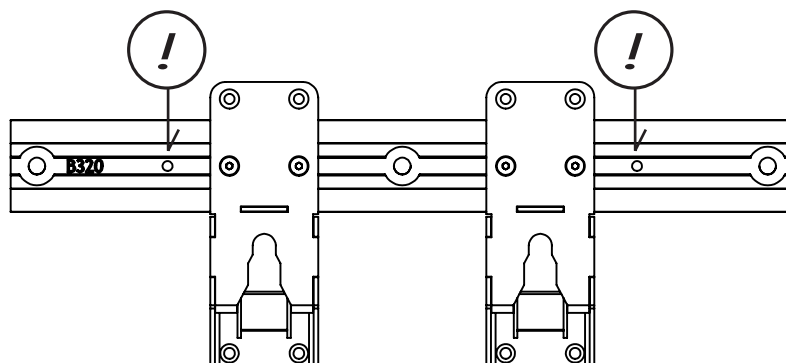

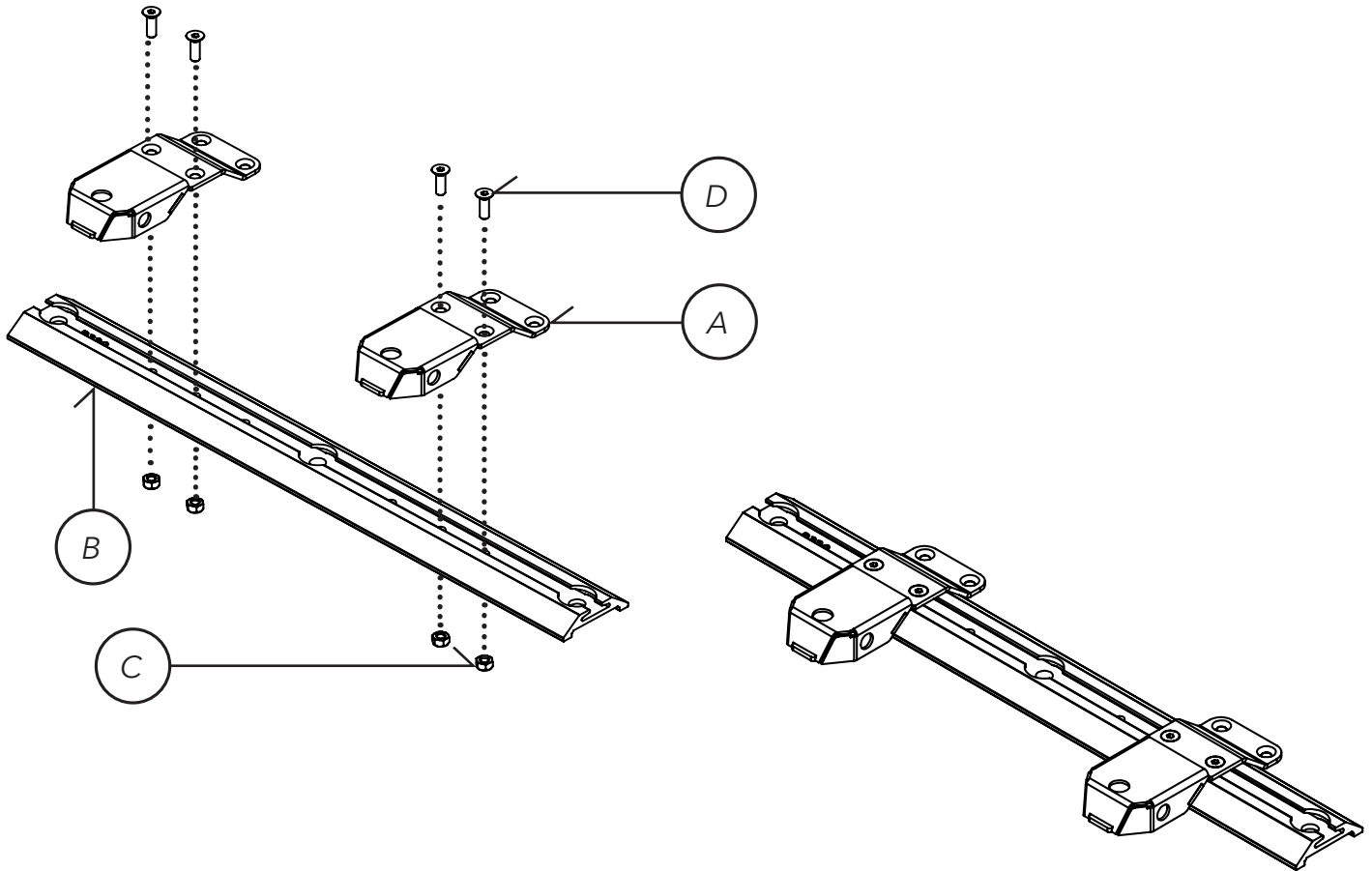

**STEP 5 - Click Brackets Assembly:**

- Securely Assemble the Click Brackets to the B320 Rail
- Click Bracket, Single Assembly shown above in exploded and assembled view.

Part Name	Quantity Required	Item
Click Bracket, Upper	2	A
B320 Mounting Rail_Install Adaptor_510mm	1	B
M6 Nut_Conelock_High Tensile Class 10_ZN_DIN980	4	C
M6 x 20_CTSK_High Tensile 12.9_ZN_BK_DIN7991	4	D

- Check and ensure all brackets are 90degrees, square to the rail.
- Secure the Click Bracket Assembly in all positions shown below. Use hand tools to tighten all fasteners. Do not over-tighten fasteners.

NOTE: The Click Brackets use 2 of 3 holes along the rail in each position, note the remaining holes as a guide of the Catch Bracket positions.

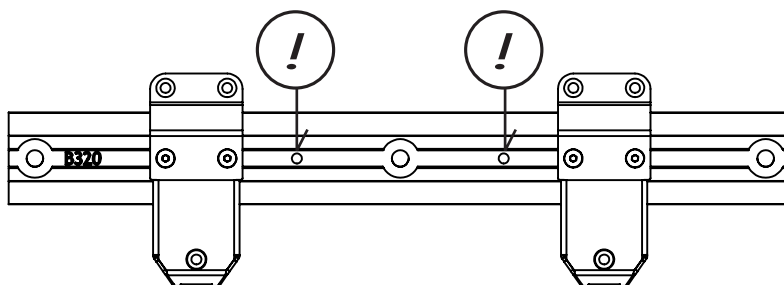

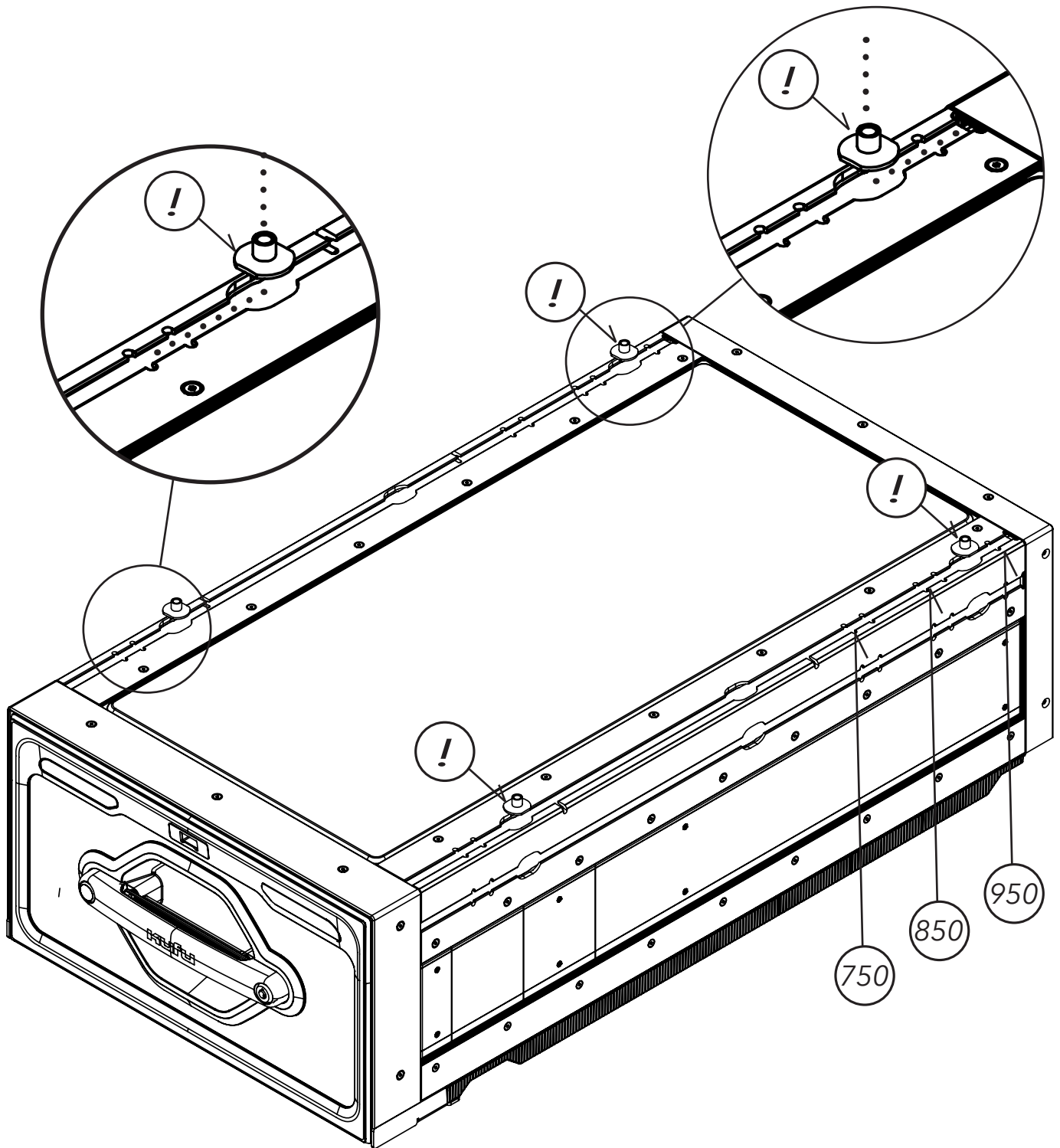

**STEP 6 - M8 Channel Stud Positions:** \*Skip this step for *ECONO* Drawers.

- Ensure the Rails are clean and free from dust or dirt that might prevent the assembly of parts.
- Fit the M8 Channel Studs in to the Rails of the KUFU Premium Drawer that will be beneath the stack.
- NOTE: Rotate the stud to align the straight edges with the rails.
- Slide the M8 Channel Studs into position indicated by the 4x notches in the Rails
- NOTE: The assembly shown above is for a 950 position stack. Other assemblies may vary depending on Drawer size beneath and Stacked position desired.

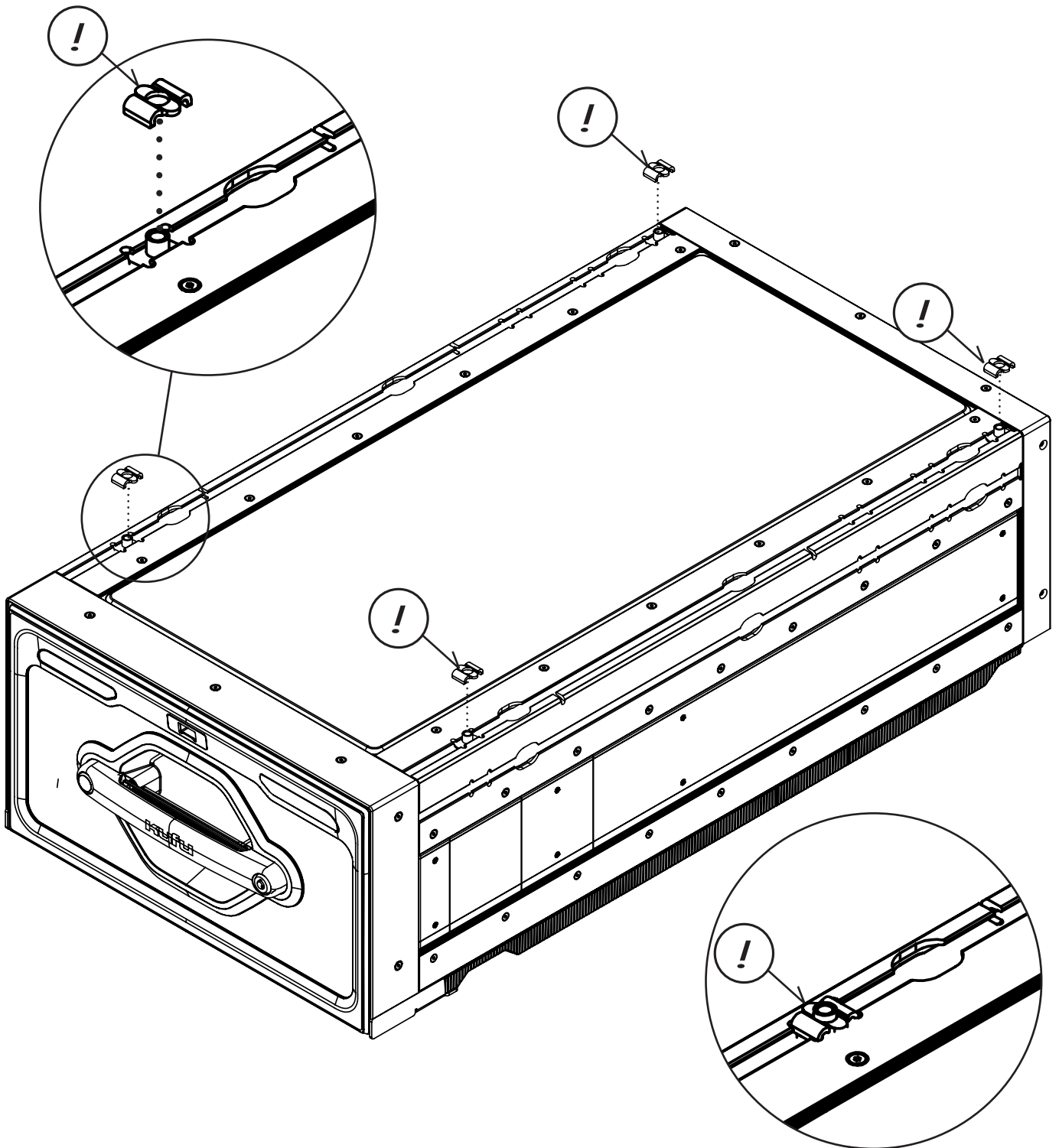

**STEP 7 - Lock Washer Assembly:** \*Skip this step for ECONO Drawers.

- Place each Lock Washer into the corresponding positions above the M8 Channel Stud, it should rest in the notches in the rail and the M8 Channel Stud should protrude through the hole of the Lock Washer.
- The Lock Washer prevents movement of the M8 Channel Stud along the rail.

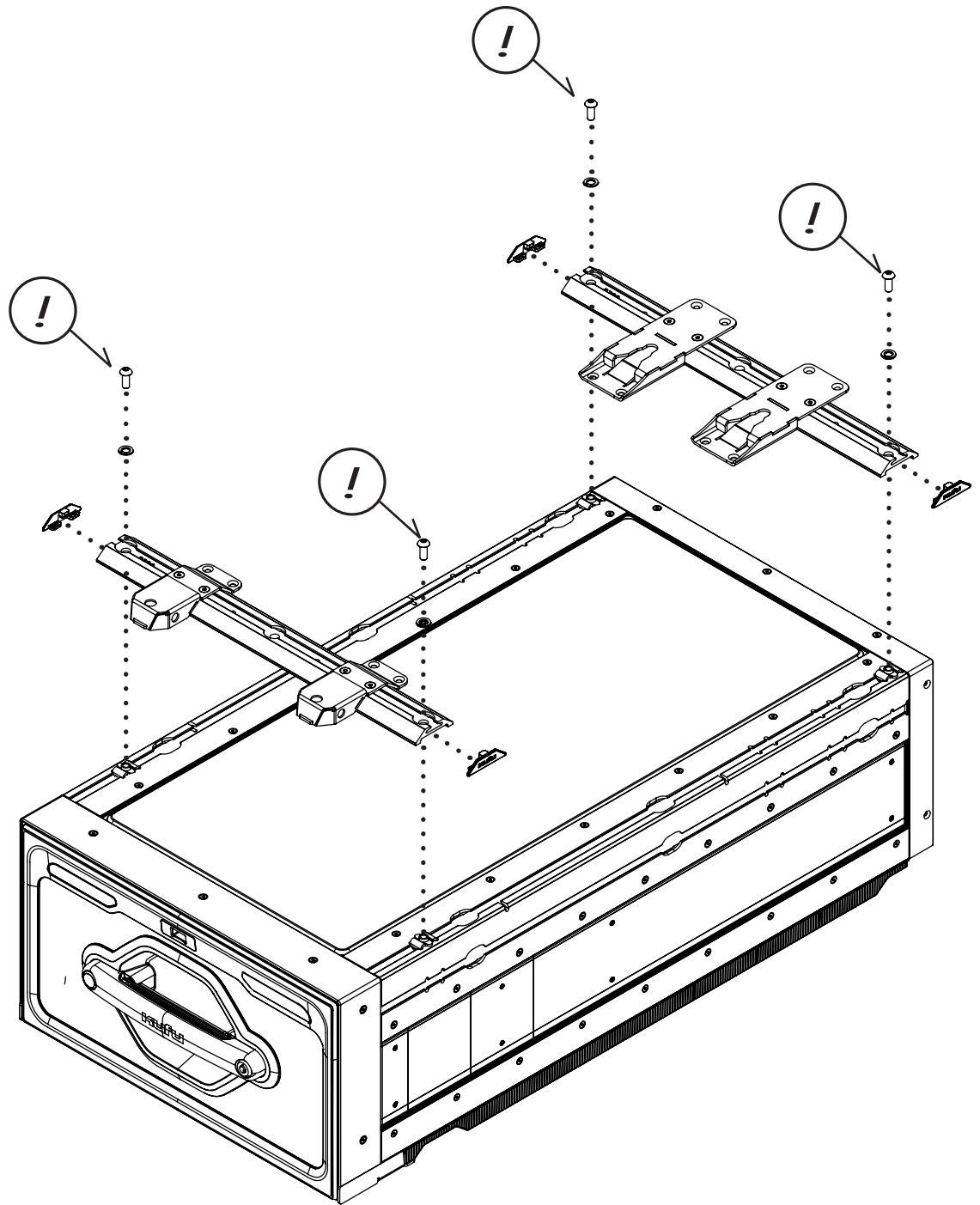

### STEP 8 - Stack Kit Assembly:

- Fit the plastic end caps to the B320 Rails before assembly.
- Using the M8 Spring Washers under the M8 Button Head Bolts provided, securely attach the pre-assembled B320 Rails to the KUFU Premium Drawer beneath.
- Securely hand tighten the fasteners.
- Ensure the B320 Rails are resting flat against the top Rails of the Drawer beneath and there is no movement.
- NOTE: For KUFU ECONO Drawers, M8 nuts are pre-assembled to the drawers during manufacture that allow for the convenient assembly of the Stack Kit.



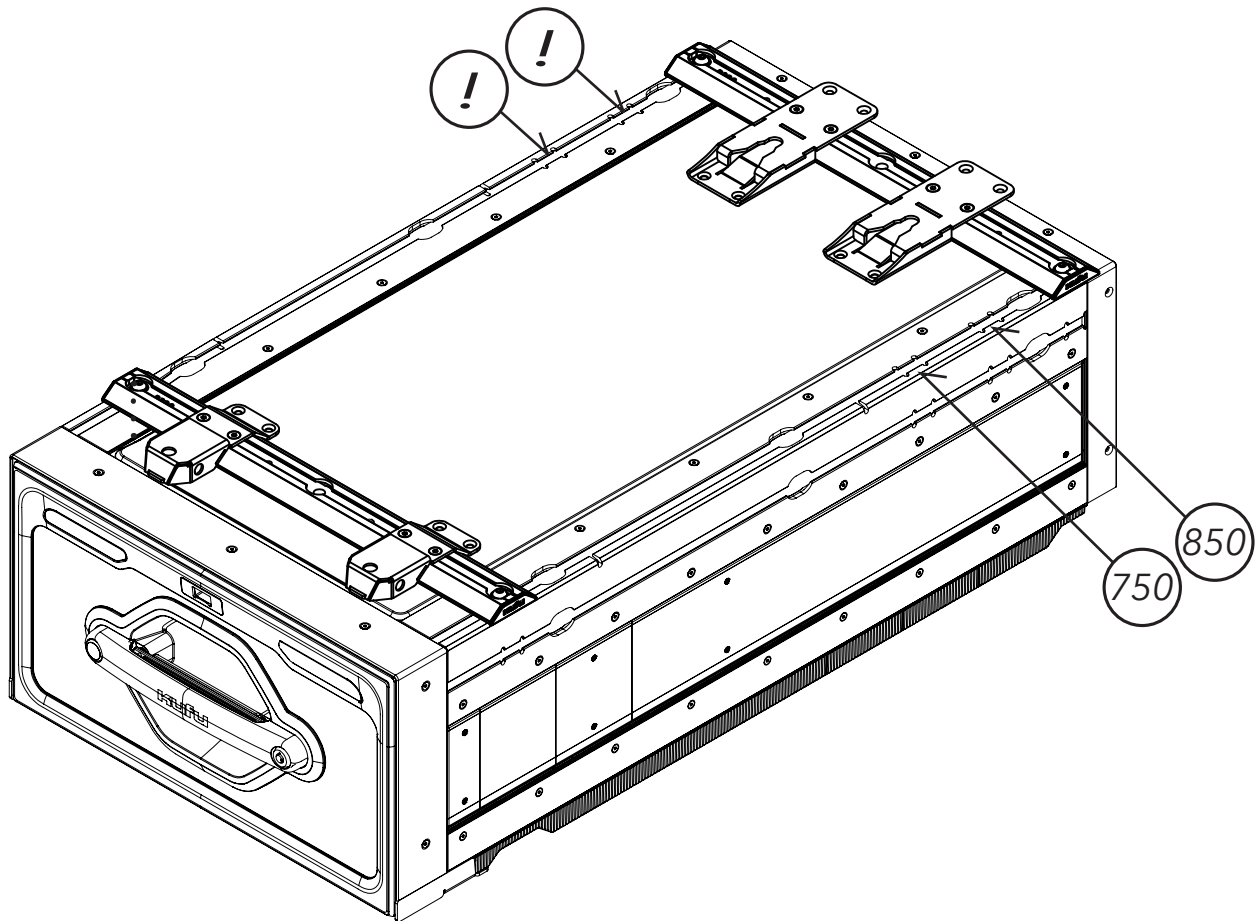

### STEP 9 - Stack Kit Assembly:

- NOTE: The Assembly shown is for a 950 KUFU System product stacked in position above a 950 Drawer.
- Longer KUFU System Products cannot be stacked onto shorter products beneath.
- Shorter KUFU System Products can be assembled on top of longer KUFU Drawer Systems,
- As shown above there are 850 and 750 sized stack positions on top of the 950 KUFU Drawer.



KUFU System

Stacking Kit, with Catch and Click Brackets Installation Guide

---

## *KUFU Drawer System*

Designed and Developed in Australia

Impact Import Group Pty. Ltd  
153 Ash Road  
Leopold, VIC 3224