



Installation Instruction Manual

1050 SUV Mounting Platform with Catch-And-Click Brackets

Version: 02

APPLICABLE VEHICLES:

- Toyota Landcruiser 200 Series.

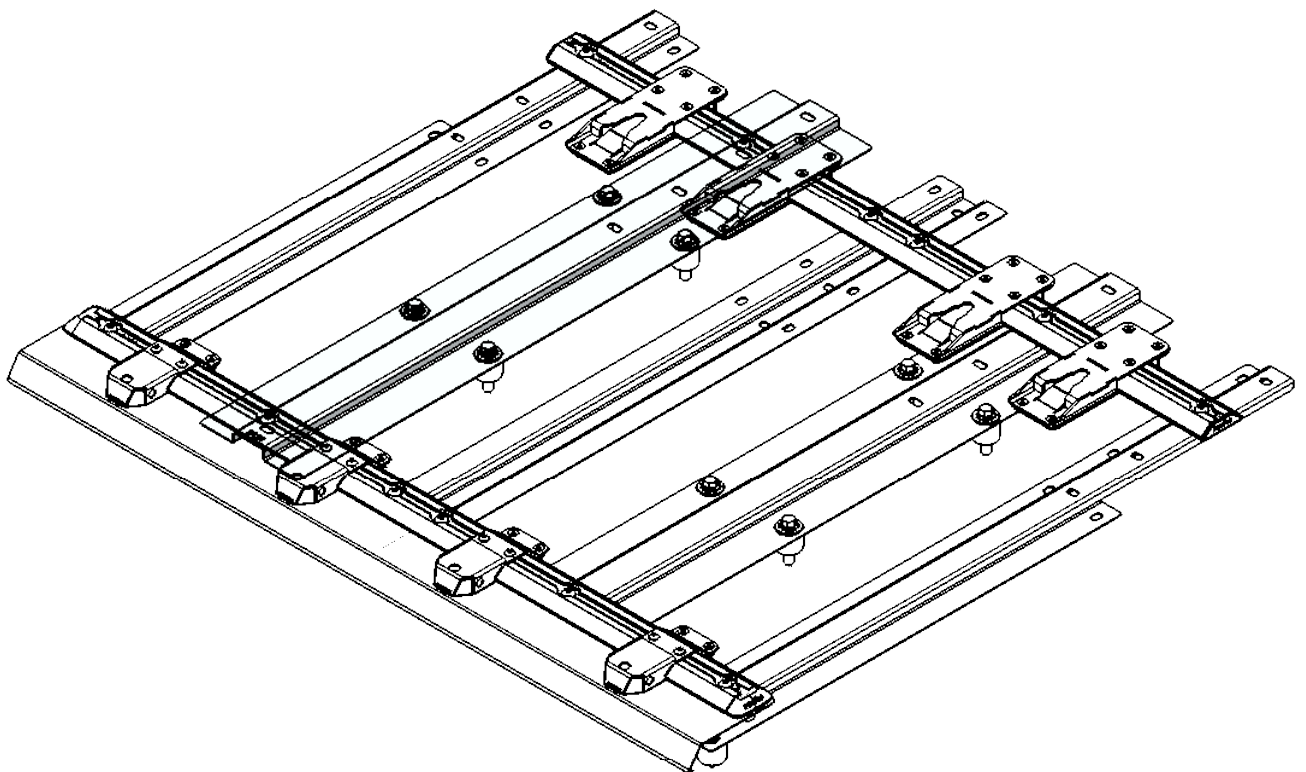

Important Information:

- This Installation Instruction Manual is for the accurate, safe and secure attachment of the 1050 SUV Mounting Platform, and Catch and Click Brackets to the vehicle.
- Open all kits to check that all parts are present.
- Follow all assembly steps in this Instruction Manual.
- Do not skip steps.
- Do not leave out fastener components from the installation steps.
- It is recommended to review the vehicle and crosscheck before making any modifications. Check to avoid damaging critical vehicle components within and beneath the vehicle.
- Use Spacer Disc parts provided or large washers to create a level installation.
- It is recommended to inform the insurance provider for the vehicle of any modifications and additions or accessories added to the vehicle, these may effect the ability to make claims depending on the level and or type of cover.
- The KUFU Drawer System and associated Mounting Platforms and Bracket Parts are designed for repeated use. However wear and tear will occur due to the nature of different materials in the assemblies and installations.
- * Note from Fornt Cover Page: Additional brackets are required for these vehicles, please get in touch to check vehicle applicability.

STEP 1 - Installation Preparation:

1. Remove 3rd row seats from the SUV or Wagon.
2. Remove any seating hitch points, trim and brackets from the floor of the vehicle.

STEP 2 - Tools Required:

- Hex Drive or Allen Key Set
- Socket Set or Spanner Set
- Utility Knife
- Tape Measure

STEP 3 - Unpack Mounting Platform:

Check the Contents of Each Kit

- B0050 Mounting Platform 1050 SUV

Part Name	Quantity
B311 Mounting Rail	2
B111 Rail Bracket Left Hand Side	1
B112 Rail Bracket Centre	1
B113 Rail Bracket Right Hand Side	1
B151 Rail Bracket Wide	2
B402 Mounting Rail End Cap_Short	2
B403 Mounting Rail End Cap_Long	4
M8 x 25mm Button Head	12
M8 Spring Washer	12
B201 M8 Channel Nut	12

- B0050 Fastener Pack - Mounting Platform 1050 SUV

Part Name	Quantity
M10 x 1.25p x 50mm Grade 8.8	8
M6 x 40mm Grade 8.8	2
10mm_Washer_Large_SS304_DIN 9021	10
Packing Disc 30mmOD x 25mm BK	10

- B0093 Combined Mounting Bracket Kit (Contents per Kit)

Part Name	Quantity
B0092 Click Bracket Assembly	2
B0090 Catch Bracket Assembly	2

- B0093 Fastener Pack - Combined Mounting Bracket Kit (Contents per Kit)

Part Name	Quantity
M6 Nut_Conelock_High Tensile Class 10_ZN_DIN980	22

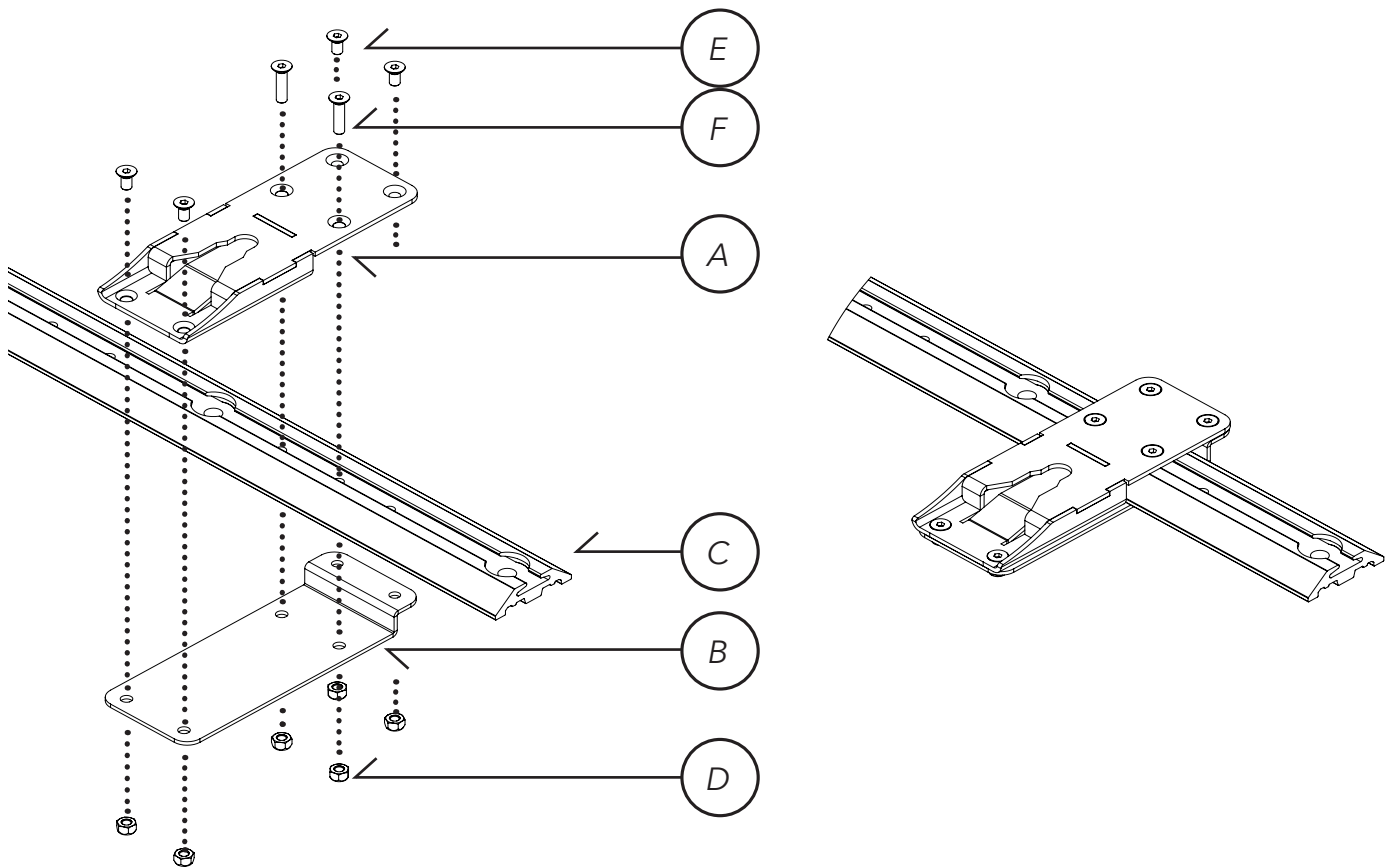

STEP 4 - Catch Brackets Assembly:

- Securely Assemble the Catch Brackets to the B311 Rail
- Catch Bracket, Single Assembly shown above in exploded view.

Part Name	Quantity	Item
Catch Bracket, Upper	1	A
Catch Bracket, Lower	1	B
B311 Rail	1	C
M6 Nut_Conelock_High Tensile Class 10_ZN_DIN980	6	D
M6 x 12_CTSK_High Tensile 12.9_ZN_BK_DIN7991	4	E
M6 x 30_CTSK_High Tensile 12.9_ZN_BK_DIN7991	2	F

- Check and ensure all brackets are 90degrees to the rail.
- Tighten the Catch Bracket Assembly in all positions shown below. Use hand tools to securely tighten all fasteners.

NOTE: The Catch Brackets use 2 of 3 holes along the rail in each position, note the remaining holes as a guide of the Catch Bracket positions.

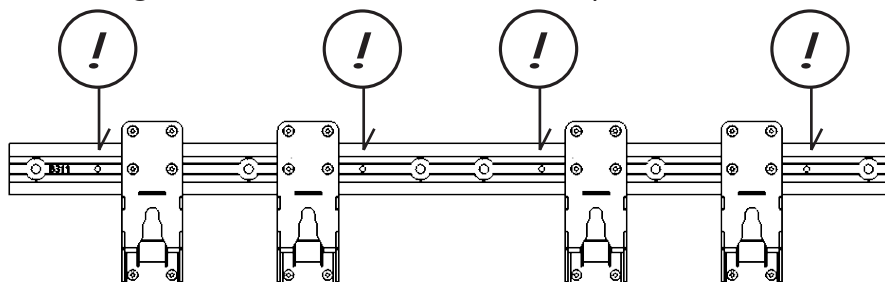

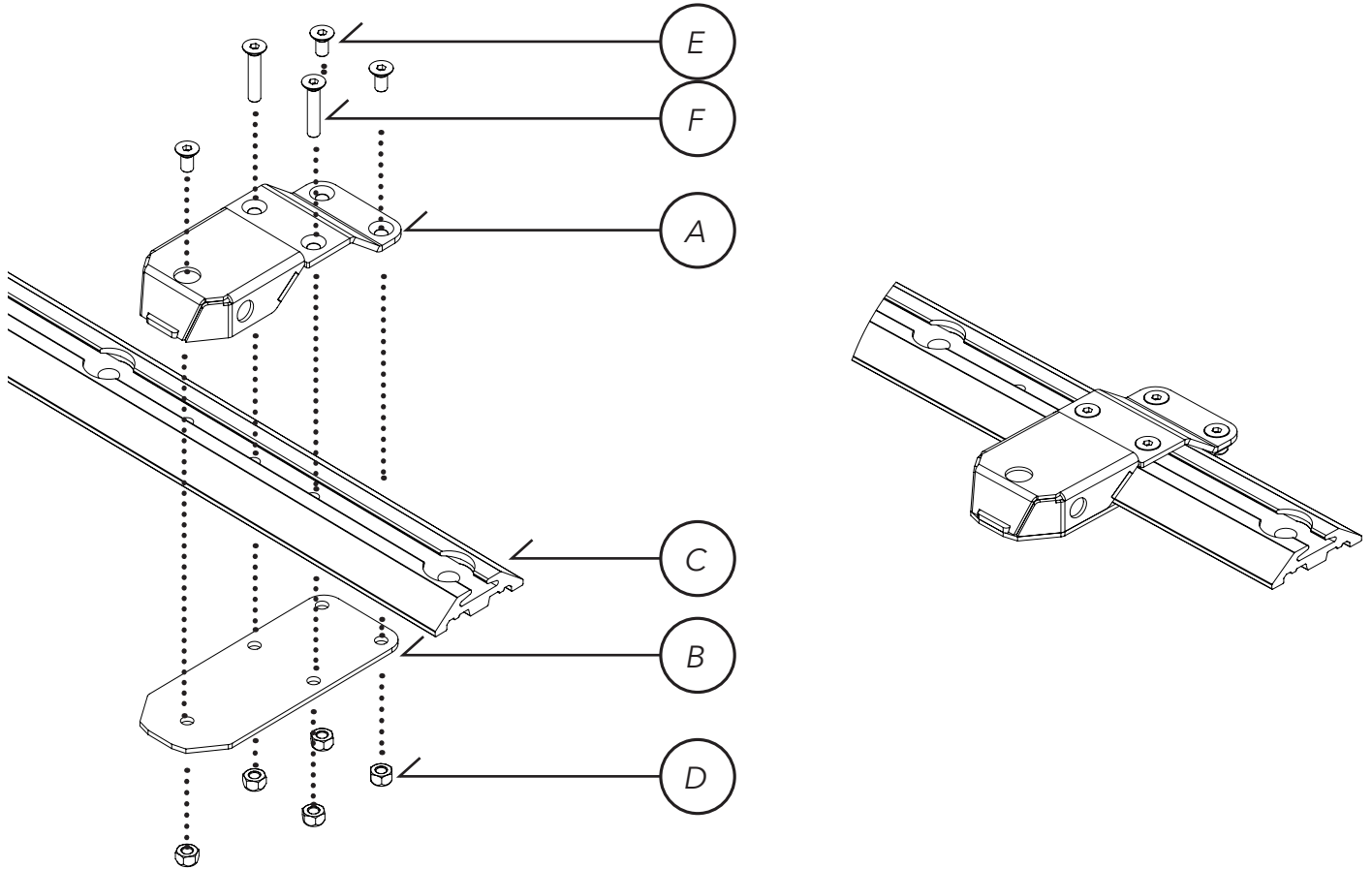

STEP 5 - Click Brackets Assembly:

- Securely Assemble the Click Brackets to the B311 Rail
- Catch Bracket, Single Assembly shown above in exploded view.

Part Name	Quantity	Item
Click Bracket, Upper	1	A
Click Bracket, Lower	1	B
B311 Rail	1	C
M6 Nut_Conelock_High Tensile Class 10_ZN_DIN980	5	D
M6 x 12_CTSK_High Tensile 12.9_ZN_BK_DIN7991	3	E
M6 x 30_CTSK_High Tensile 12.9_ZN_BK_DIN7991	2	F

- Check and ensure all brackets are 90degrees to the rail.
- Tighten the Click Bracket Assembly in all positions shown below. Use hand tools to securely tighten all fasteners.

NOTE: The Click Brackets use 2 of 3 holes along the rail in each position, note the remaining holes as a guide of the Click Bracket positions.

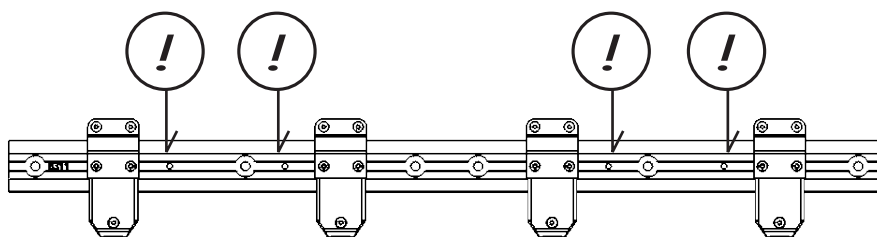

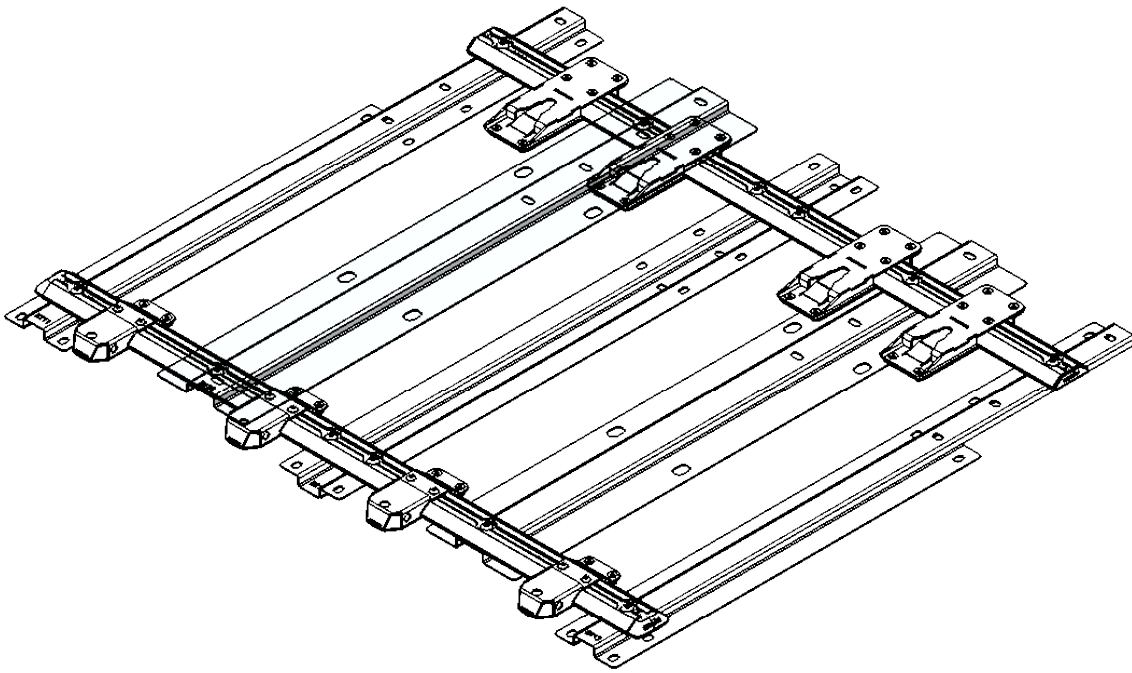

STEP 6 - Assemble the Mounting Platform 1050 SUV:

- Layout all parts on a flat work surface, nearby the vehicle.
- The pre-assembled Mounting platform is loosely secured together before being placed in to the SUV or wagon for the assembly.
- Catch and Click Brackets must be assembled to the Mounting Rails before this step.
- Do not tighten fasteners in the following steps until the Mounting platform is placed in to the vehicle.
- M8 Channel Nuts are designed to fit under the Rail Brackets and should only need to be tightened from above.

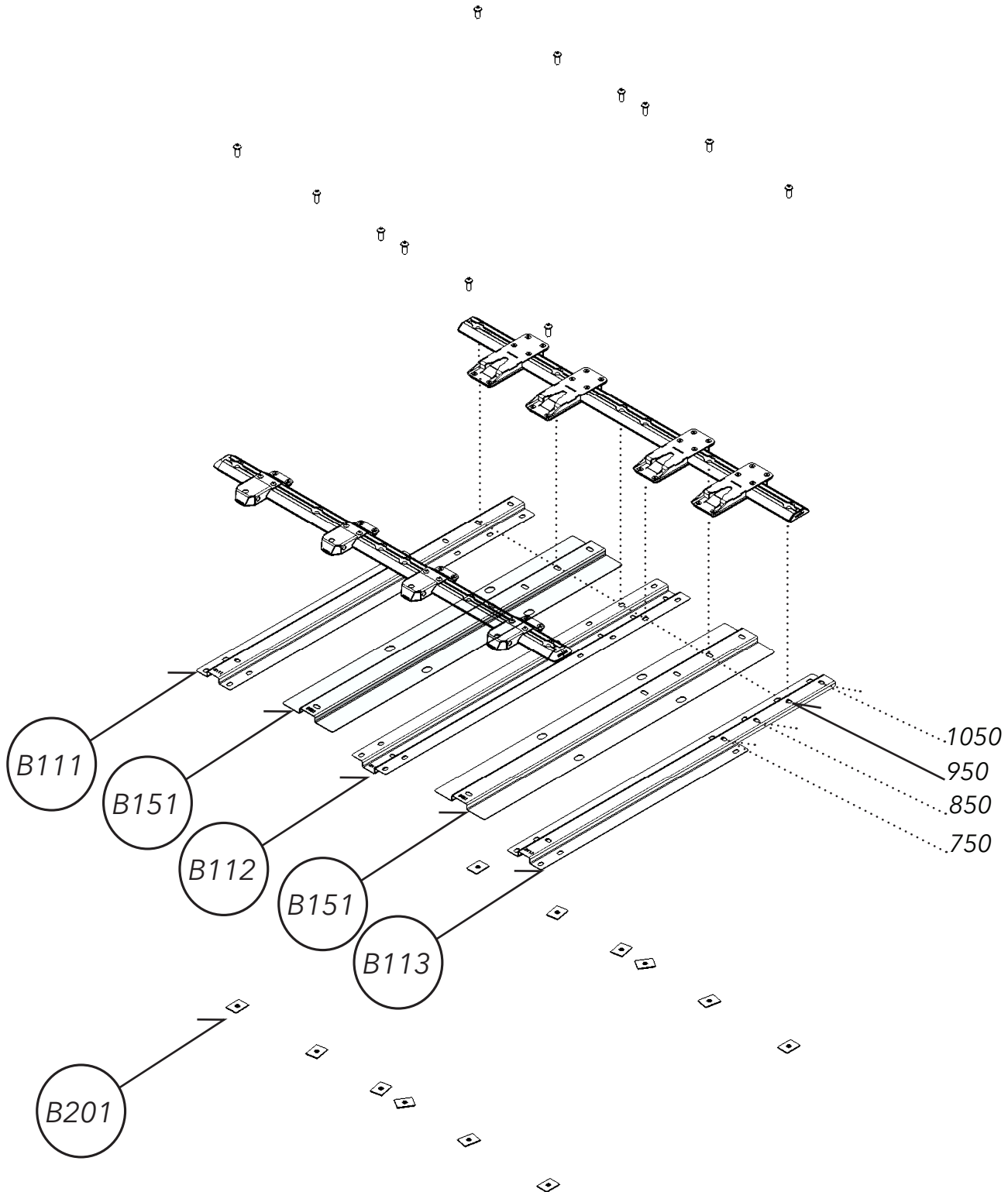

STEP 7 - Assemble the Mounting Platform Frame:

- Use M8 x 25 fasteners and Spring Washer passing through the Rails to each Bracket. Place the M8 Channel Nut flat side up toward the bracket.
- Secure the Rail with Catch Brackets into the corresponding hole positions for the Drawer depth you are planning to install: 750, 850, 950 or 1050 Drawer Sizes.
- Loosely secure the parts.

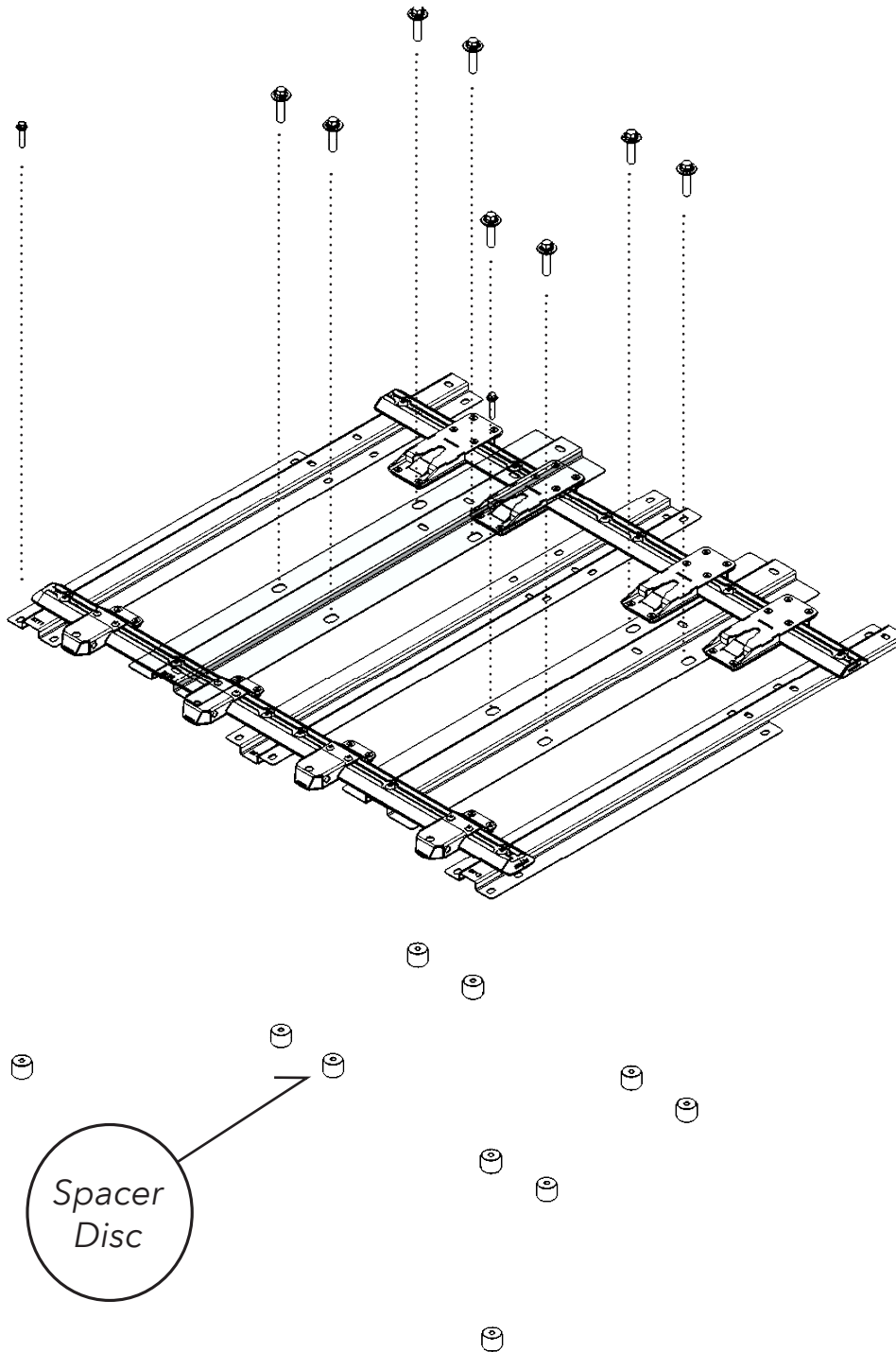

STEP 8 - Position Spacers above Vehicle Mounting points:

- Use Spacer Disc placed above the vehicle mounting points to raise the Mounting Platform Assembly
- Place the assembled Mounting Platform over the Spacer Discs
- Use a large washer then bolt and loosely fasten the Mounting Platform into position

IMPORTANT: Do not tighten fasteners before checking for level and square of the Mounting Platform.

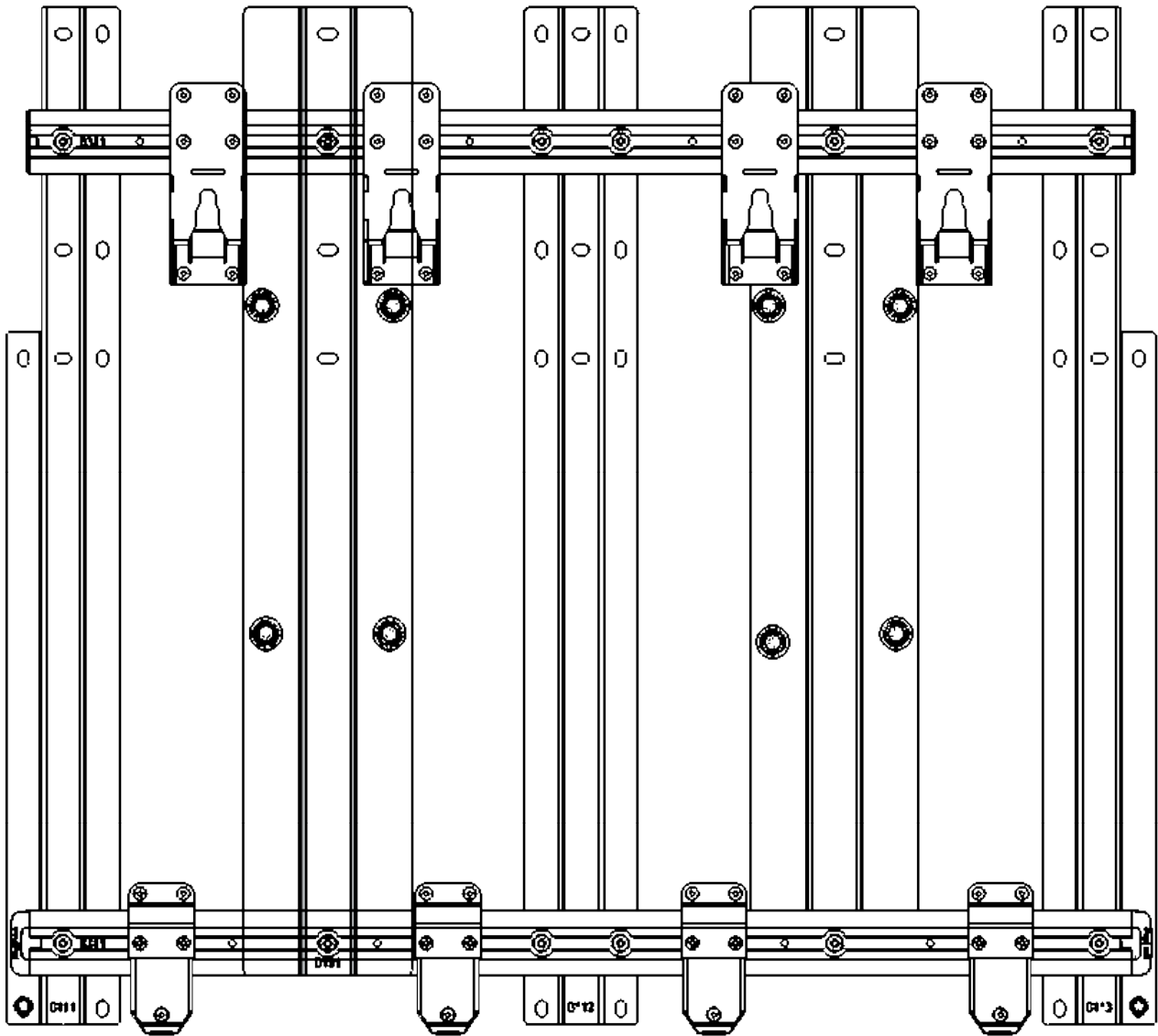

STEP 9 - Check Assembly is Level, Aligned and Square:

- Rails and brackets should be 90degrees / perpendicular to each other.
- The Rails should be parallel and the ends of the Rails should be aligned.
- If more spacers are required to achieve a level assembly place washer(s) under the Rail Brackets to raise the the Frame.

IMPORTANT: Do not tighten fasteners before checking for level and square of the Mounting Platform.

STEP 10 - Tighten the Vehicle Fasteners:

- Tighten the Fasteners securing the Rail Brackets to the Vehicle.

IMPORTANT: Do not over tighten. Hand tighten using a socket or spanner only.

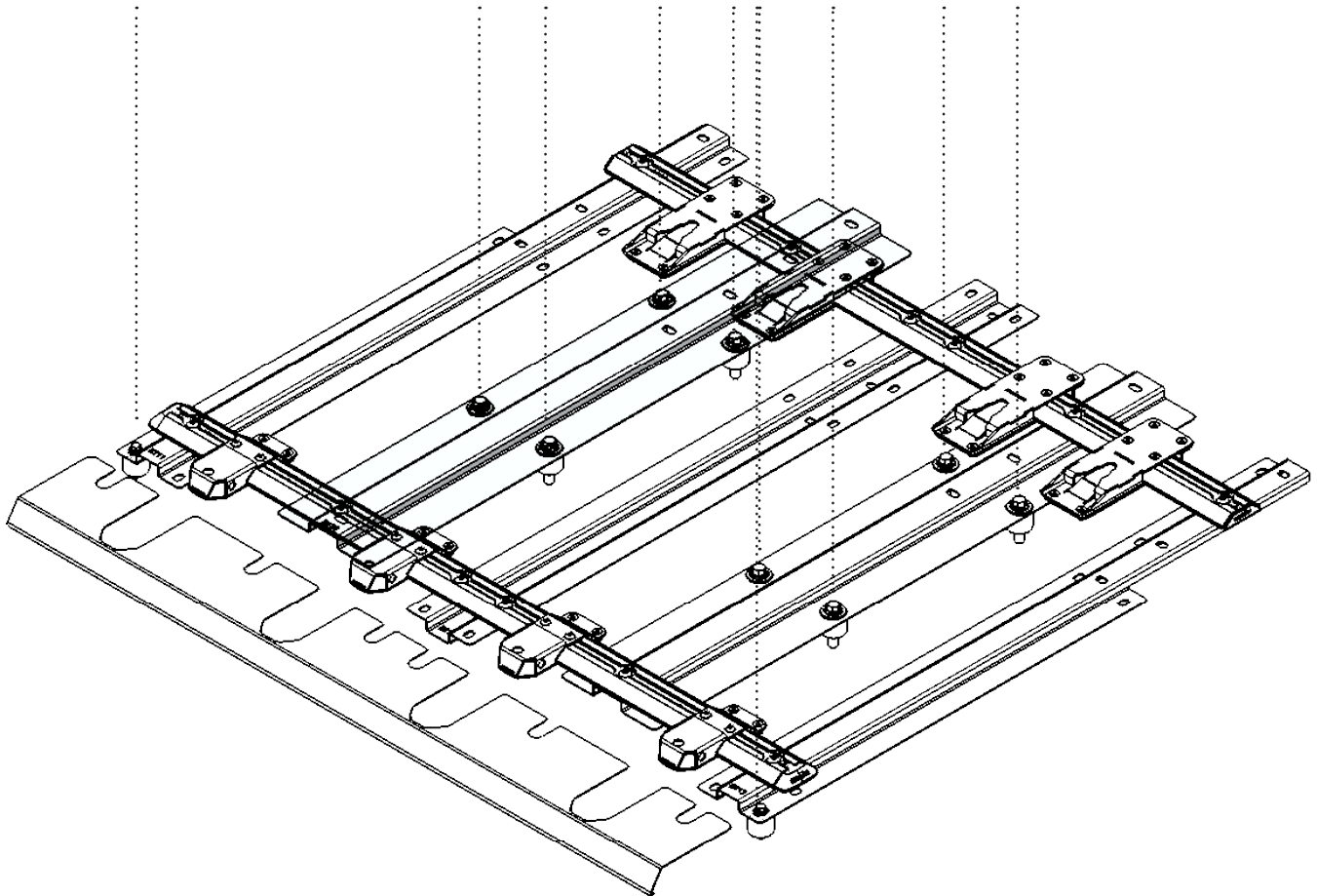

STEP 11 - Fit Trim under the Rail:

- Fit the Trim Bracket underneath the Rail
- Loosen the M8 x 25mm Button Head fasteners to allow the trim to fit under the Rail and above the Rail Brackets.

STEP 12 - Tighten the Mounting Platform Frame Fasteners:

- Using an Allan Key Tighten the M8 x 25mm Button Head fasteners securing the Rails to the Rail Brackets.
- No tool should be required for the M8 Channel nut, facing flat side up to the underside of the Rail Brackets.

IMPORTANT: Do not over tighten. Hand tight using a socket or spanner only.

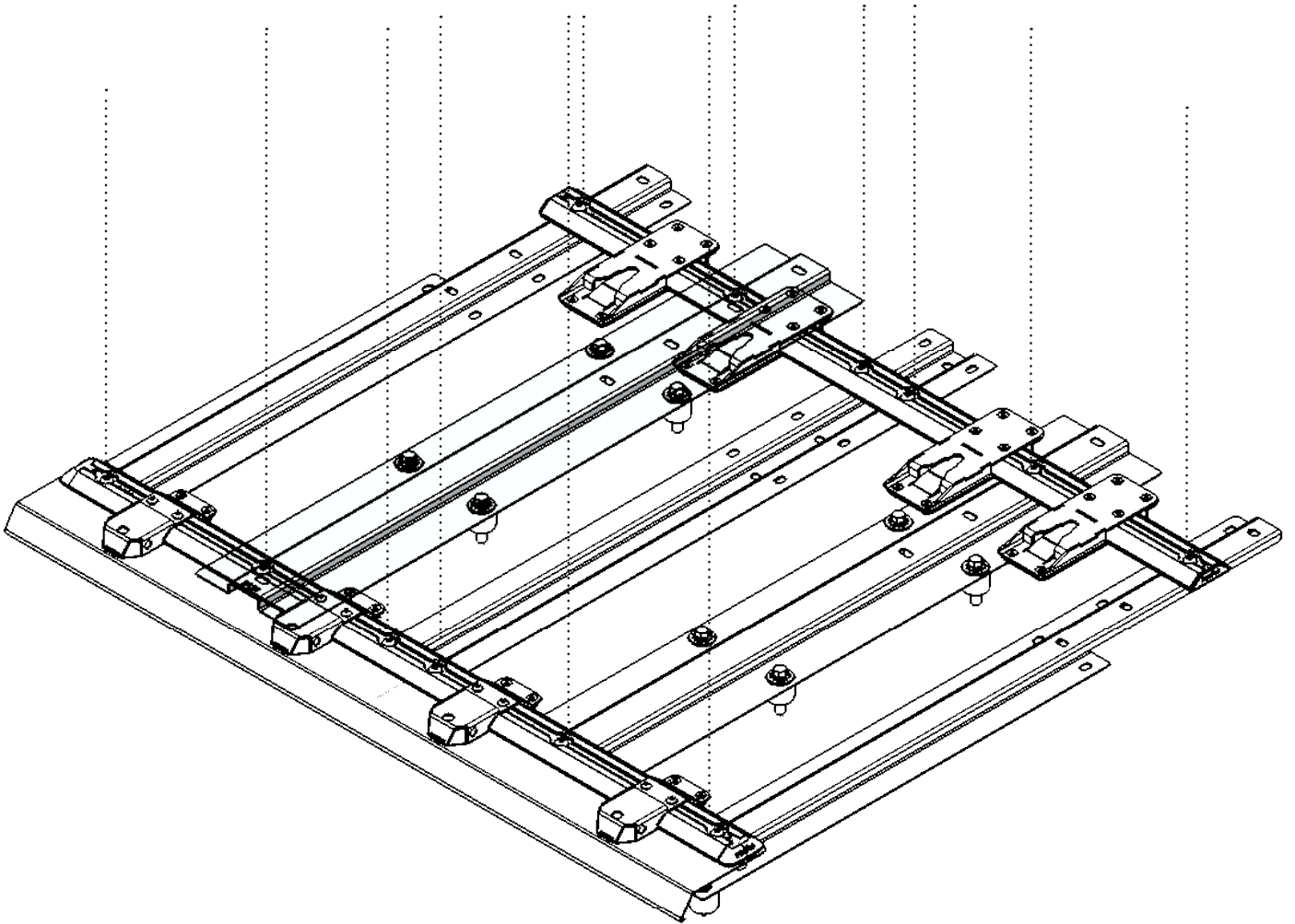

STEP 13 - Double check the assembly is flat and level:

- All Bracket and Rails should be flat and level
- Components should be consistent

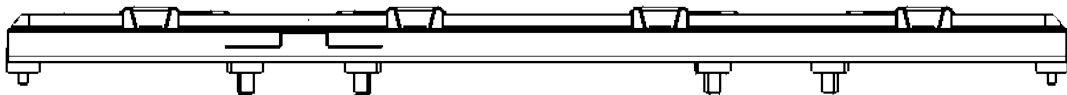

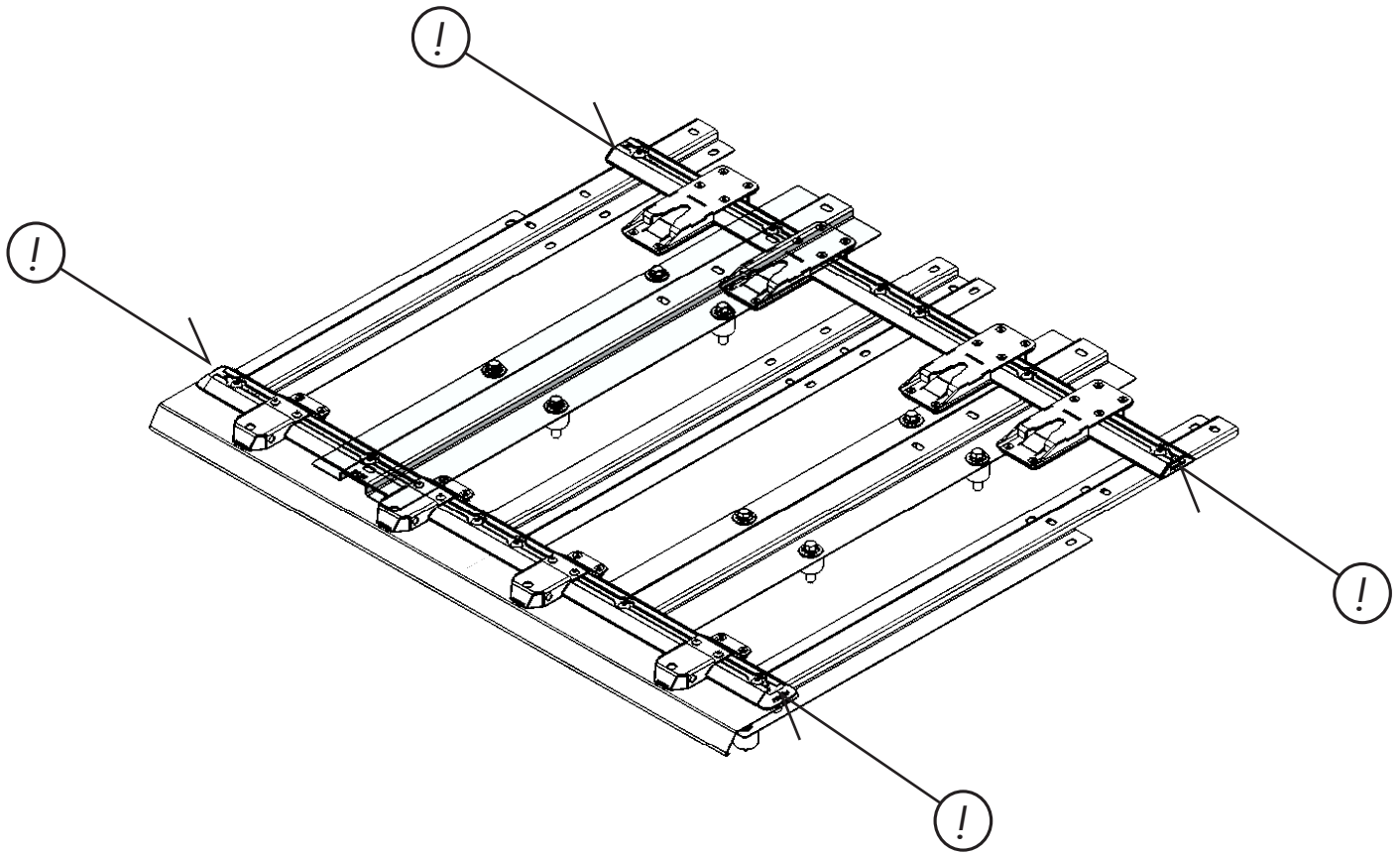

STEP 14 - Assemble the End Caps, Long and Short, x4 positions

KUFU Drawer System

Designed and Assembled in Australia
www.kufu.com.au | sales@kufu.com.au

Impact Import Group Pty. Ltd
153 Ash Road
Leopold, VIC 3224
info@impactimport.com.au