



KUFU System Prado150 & 4Runner Mounting Platform Install Guide

Version: 02

VEHICLE REFERENCE:

Toyota Prado 150, Australia
3rd Row Seats Removed.
Toyota 4Runner 5th Gen, USA
3rd Row Seats Removed.

Important Information:

- This Installation Instruction Manual is for the accurate, safe and secure attachment of the 1050 SUV Mounting Platform, and Catch and Click Brackets to the vehicle.
- Open all kits to check that all parts are present.
- Follow all assembly steps in this Instruction Manual.
- Do not skip steps.
- Do not leave out fastener components from the installation steps.
- It is recommended to review the vehicle and crosscheck before making any modifications. Check to avoid damaging critical vehicle components within and beneath the vehicle.
- Use Spacer Disc parts provided or large washers to create a level installation.
- It is recommended to inform the insurance provider for the vehicle of any modifications and additions or accessories added to the vehicle, these may effect the ability to make claims depending on the level and or type of cover.
- The KUFU Drawer System and associated Mounting Platforms and Bracket Parts are designed for repeated use. However wear and tear will occur due to the nature of different materials in the assemblies and installations.
- Please Note: Additional brackets are required for different vehicle installations, please get in touch to check vehicle applicability.

A KUFU System Mounting Platform installation for:
Toyota Prado 150 (AUS)
or
Toyota 4Runner (USA)

Shown below are vehicle bracket parts B276 and B275, these brackets suit the floor of the vehicle. Vehicle model variations may require alternative brackets and / or fasteners.

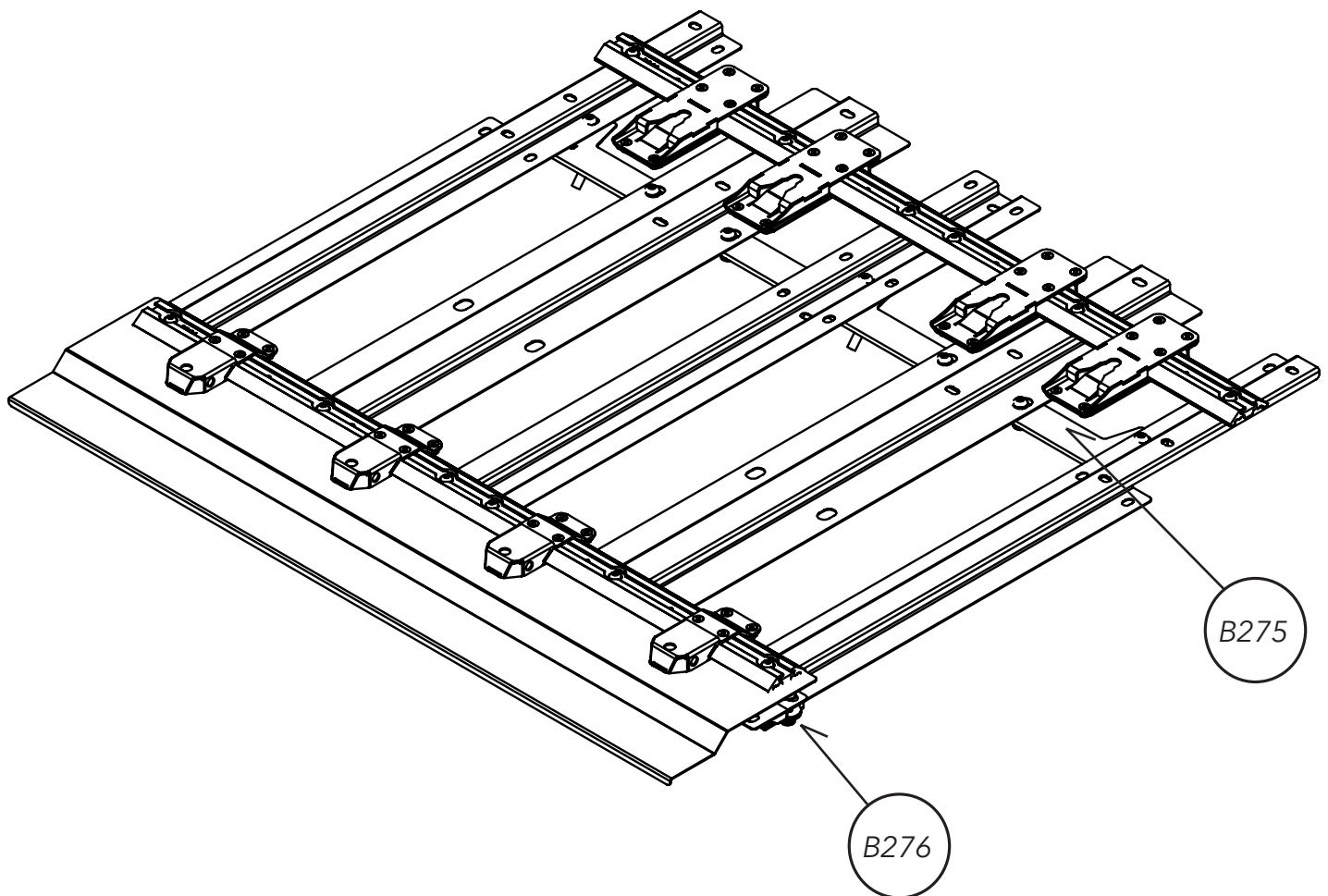

STEP 1 - Installation Preparation:

- Remove 3rd row seats from the SUV or Wagon.
- Remove any seating hitch points, trim, trays, carpet and brackets from the floor of the vehicle.

STEP 2 - Tools Required:

- Hex Drive or Allen Key Set
- Socket Set or Spanner Set
- Utility Knife
- Tape Measure

STEP 3 - Components:

- Prado 150 / 4 Runner Mounting Platform Kit 1050 SUV

Part Name	Quantity
B275 Prado 150_4Runner_Mounting Bracket_Front	1
B276 Prado 150_4Runner_Mounting Bracket_Rear	1
B277 Prado 150_4Runner_Trim_Full Width	1
B311 Mounting Rail	2
B111 Rail Bracket Left Hand Side	1
B112 Rail Bracket Centre	1
B113 Rail Bracket Right Hand Side	1
B151 Rail Bracket Wide	2
B402 Mounting Rail End Cap_Short	2
B403 Mounting Rail End Cap_Long	4
M8 x 25mm Button Head Bolt	24
M8 Spring Washer	12
B201 M8 Channel Nut	12
10mm_Washer_Large_SS304_DIN 9021	32
M10 x 25mm Bolt Fine Thread	8
M8 x Nyloc Nut	12

- B0093 Catch and Click Bracket Kit. Contents per Kit. 1x Kit required per Drawer

Part Name	Quantity
B0092 Click Bracket Assembly	2
B0090 Catch Bracket Assembly	2

- B0093 Fastener Pack - Contents per Kit. 1x Kit required per Drawer

Part Name	Quantity
M6 Nut_Conelock_High Tensile Class 10_ZN_DIN980	22
M6 x 12_CTSK_High Tensile 12.9_ZN_BK_DIN7991	14
M6 x 30_CTSK_High Tensile 12.9_ZN_BK_DIN7991	8

- NOTE: Every KUFU Drawer or Accessory requires a Catch and Click Bracket set to secure the product to the vehicle. KUFU System Products can be attached to a Mounting Platform or Stacked above other KUFU products, make sure you have the required amount of Catch and Click Brackets for your installation.

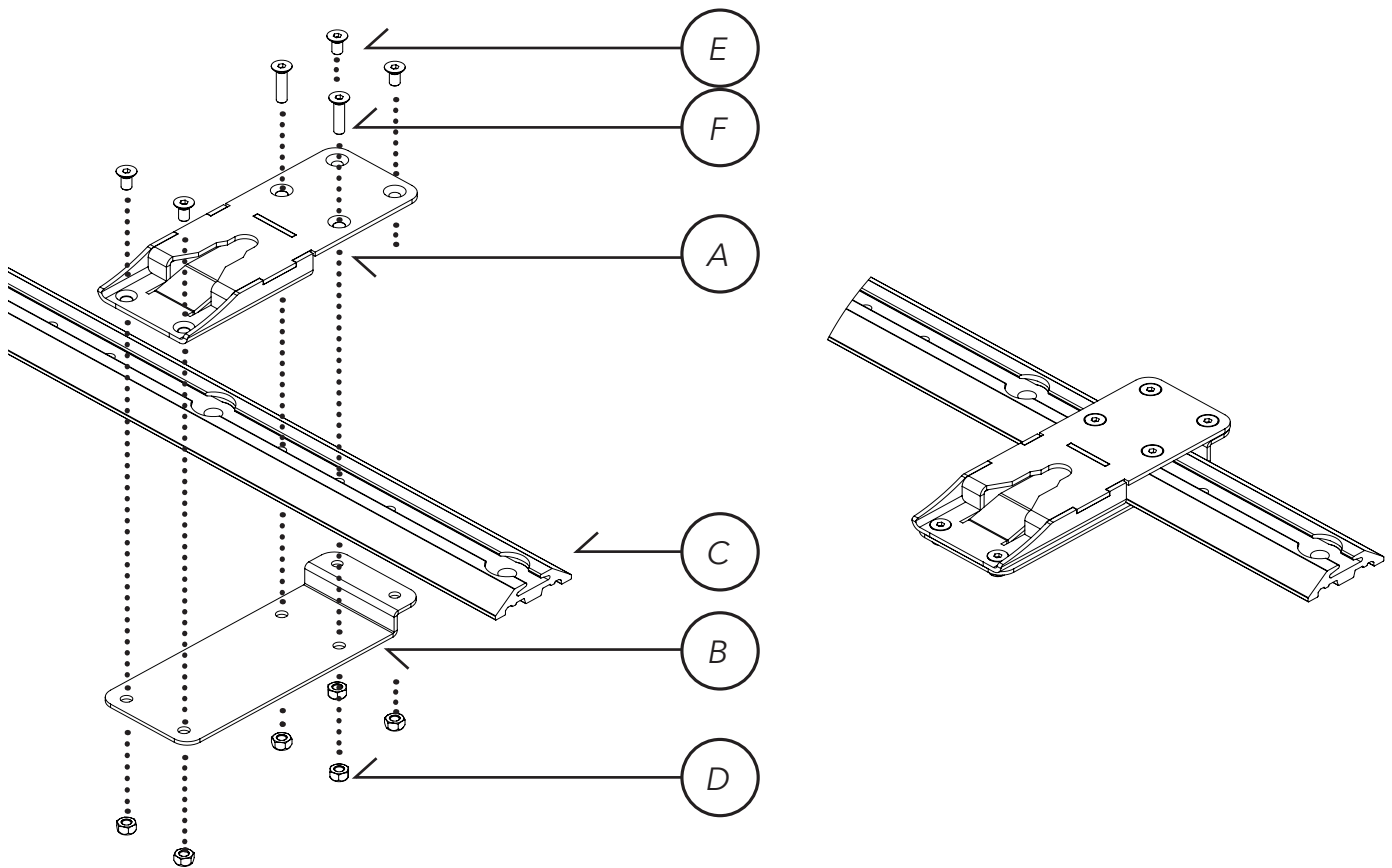

STEP 4 - Catch Brackets Assembly:

- Securely Assemble the Catch Brackets to the B311 Rail
- Catch Bracket, Single Assembly shown above in exploded view.

Part Name	Quantity	Item
Catch Bracket, Upper	1	A
Catch Bracket, Lower	1	B
B311 Rail	1	C
M6 Nut_Conelock_High Tensile Class 10_ZN_DIN980	6	D
M6 x 12_CTSK_High Tensile 12.9_ZN_BK_DIN7991	4	E
M6 x 30_CTSK_High Tensile 12.9_ZN_BK_DIN7991	2	F

- Check and ensure all brackets are 90degrees to the rail.
- Tighten the Catch Bracket Assembly in all positions shown below. Use hand tools to securely tighten all fasteners.

NOTE: The Catch Brackets use 2 of 3 holes along the rail in each position, note the remaining holes as a guide of the Catch Bracket positions.

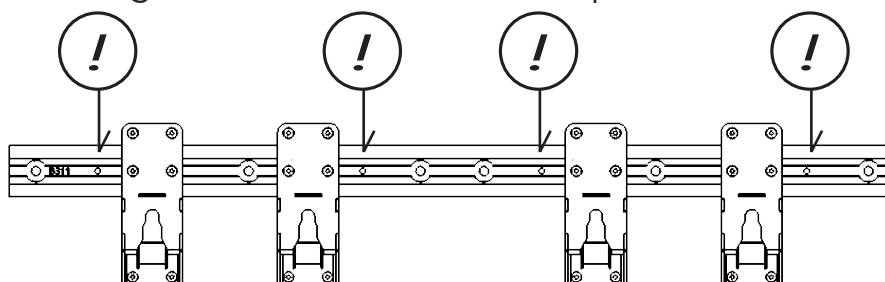

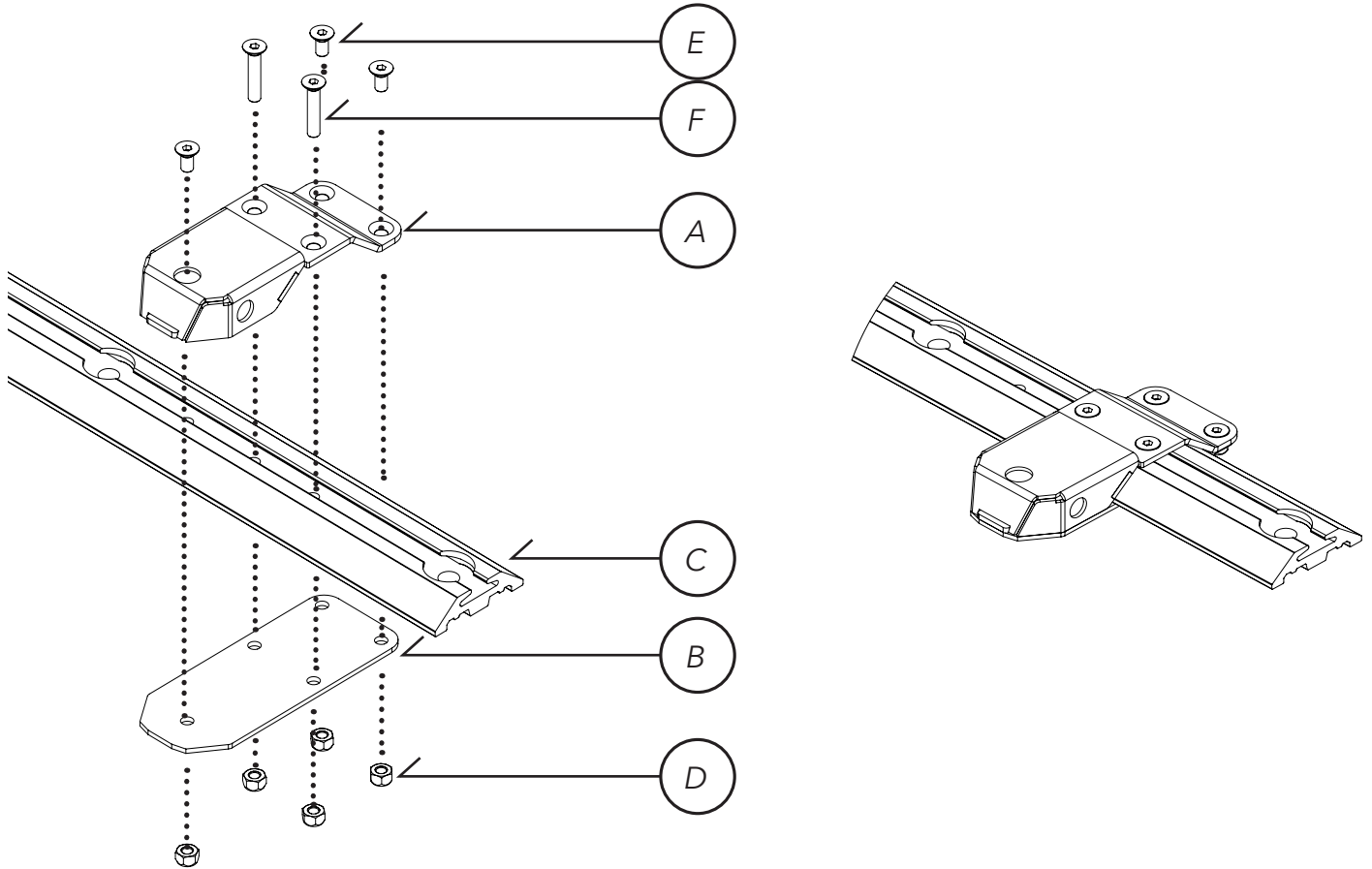

STEP 5 - Click Brackets Assembly:

- Securely Assemble the Click Brackets to the B311 Rail
- Catch Bracket, Single Assembly shown above in exploded view.

Part Name	Quantity	Item
Click Bracket, Upper	1	A
Click Bracket, Lower	1	B
B311 Rail	1	C
M6 Nut_Conelock_High Tensile Class 10_ZN_DIN980	5	D
M6 x 12_CTSK_High Tensile 12.9_ZN_BK_DIN7991	3	E
M6 x 30_CTSK_High Tensile 12.9_ZN_BK_DIN7991	2	F

- Check and ensure all brackets are 90degrees to the rail.
- Tighten the Click Bracket Assembly in all positions shown below. Use hand tools to securely tighten all fasteners.

NOTE: The Click Brackets use 2 of 3 holes along the rail in each position, note the remaining holes as a guide of the Click Bracket positions.

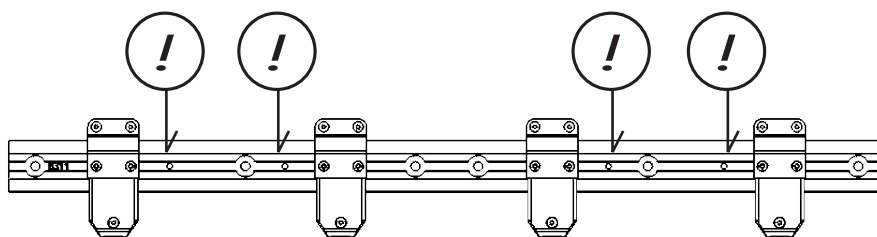

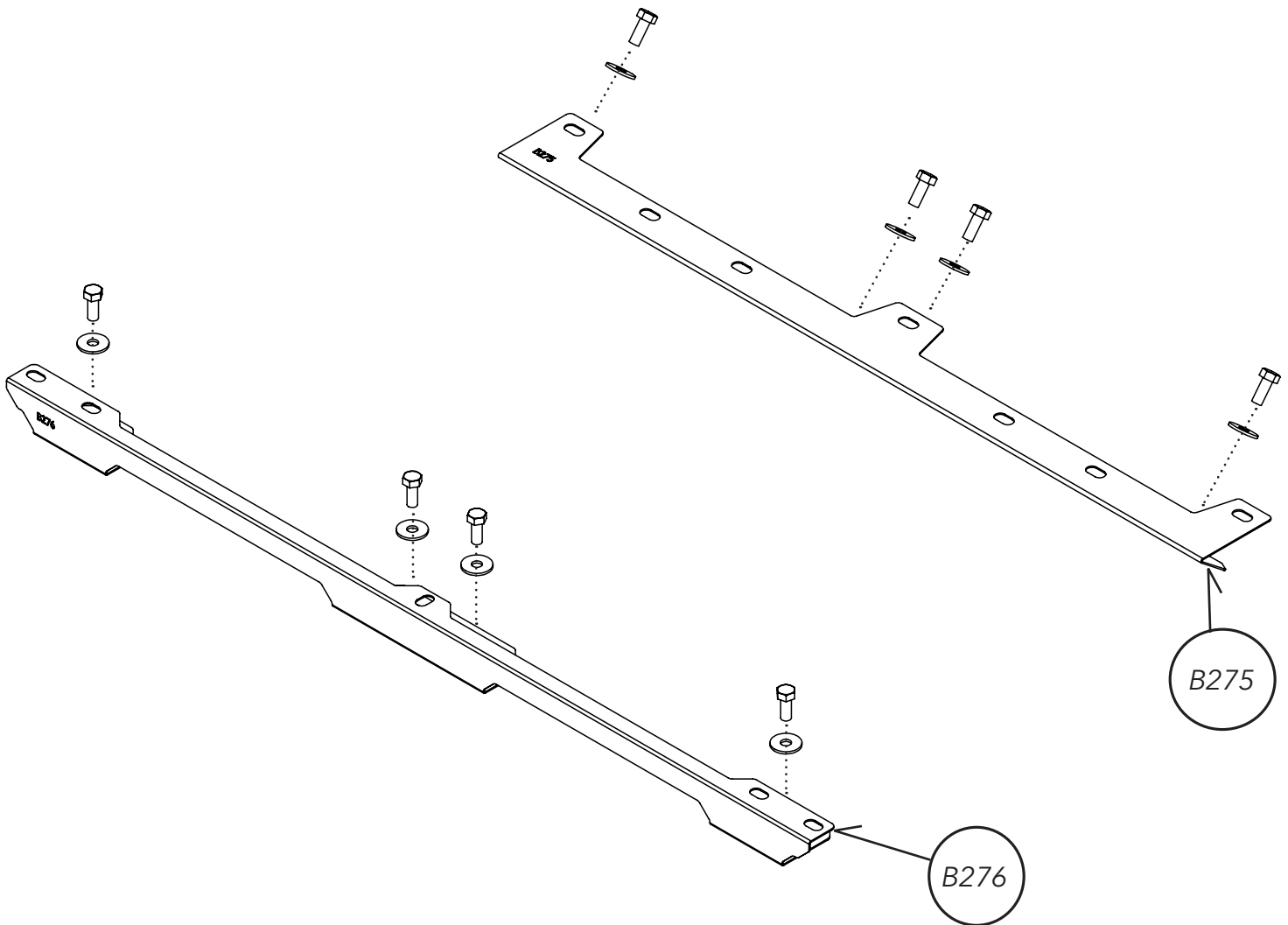

STEP 6 - Vehicle Floor Bracket Assembly:

- Install the B275 Bracket to the forward position of the vehicle.
- Securely attach bracket B275 to the vehicle, using washers underneath the bracket to keep it flat when fasteners are tightened. Use washers underneath the bolt heads to secure the bracket in position. Hand tighten only.
- Review the hole alignment of the B276 Bracket to the vehicle floor.
- NOTE: Some vehicle models will not have all corresponding bracket holes.
- Securely attached bracket B276 to the vehicle using fasteners provided into existing threaded points where possible. Use washers underneath the bracket to keep it flat when fasteners are tightened. Use washers underneath the bolt heads to secure the bracket in position.
- NOTE: If there are missing threaded mounting holes in the floor of the vehicle, due to model variations, then consider drilling pilot holes to use other fasteners to secure brackets to the vehicle body. Follow the guiding steps on the following pages for alternative methods to secure the brackets to the floor of the vehicle.

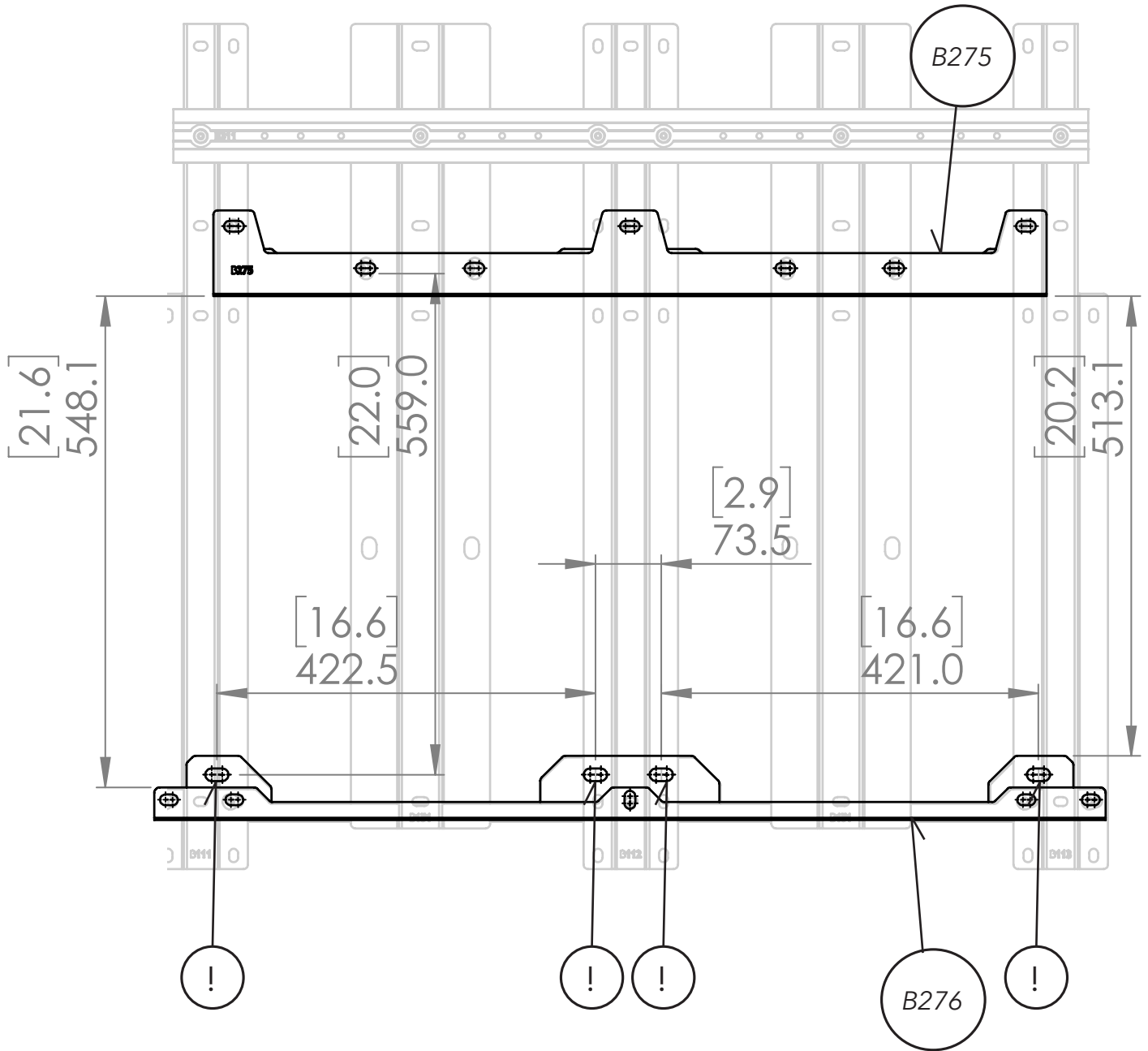

STEP 7 - Vehicle Floor Brackets Continued:

- Vehicle floor brackets are highlighted above with key dimensions for reference.
- Some threaded holes may exist, which can assist the alignment of brackets.
- If no holes exist for alignment, please use the guiding dimensions to position the B276 Bracket.
- NOTE: Some vehicles without threaded mounting holes in the vehicle floor will need pilot holes for inspection. Mark the pill-shaped holes where more fasteners are required, this marking is for small centred pilot-holes and further inspection.
- Thoroughly inspect the underside of the vehicle to ensure it is safe to drill pilot holes. DO NOT proceed if there is any doubt or risk of damage to any components.

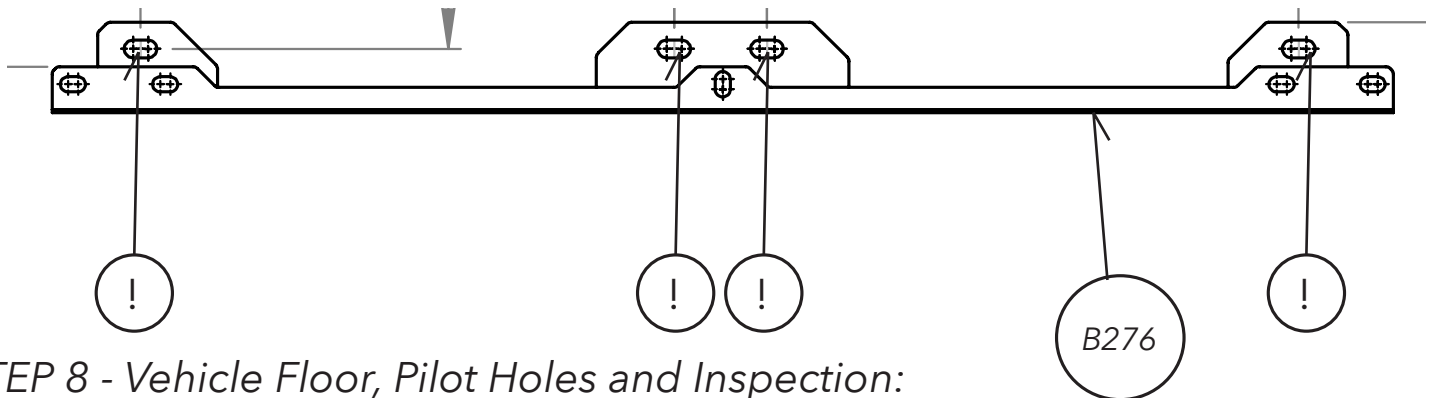
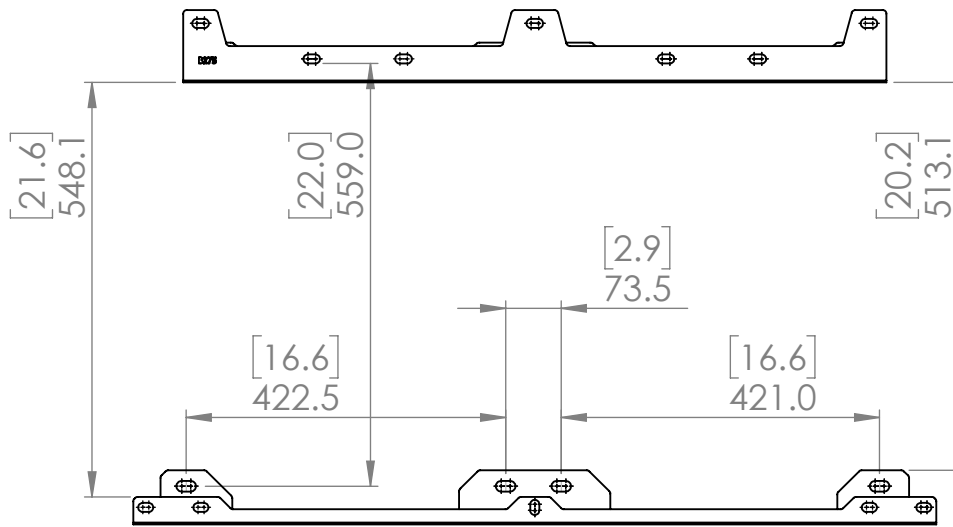

STEP 8 - Vehicle Floor, Pilot Holes and Inspection:

- Thoroughly inspect the underside of the vehicle body and check for critical components that could be damaged. Do not drill if there are components or parts attached to the vehicle underbody adjacent or near to the potential hole positions.
- However, if there is clearance underneath the vehicle body, pilot holes can be drilled to accurately inspect the positions.
- At the hole positions as shown above (!) x4 drill small holes, 2 - 3mm Diameter MAX. Minimise how far the drill bit protrudes through the vehicle body to reduce the risk of damage.
- Inspect the underside of the vehicle body to locate the pilot holes. Check for a flat surface for a washer and nut to be fastened against.
- OR if there is no pilot hole visible, a channel may be hiding the hole position. If this is the case, a steel Rivnut may be used instead of a bolt, washer and nut. Rivnuts are not provided.
- Securely fasten bracket B276 to the vehicle floor in the position shown.

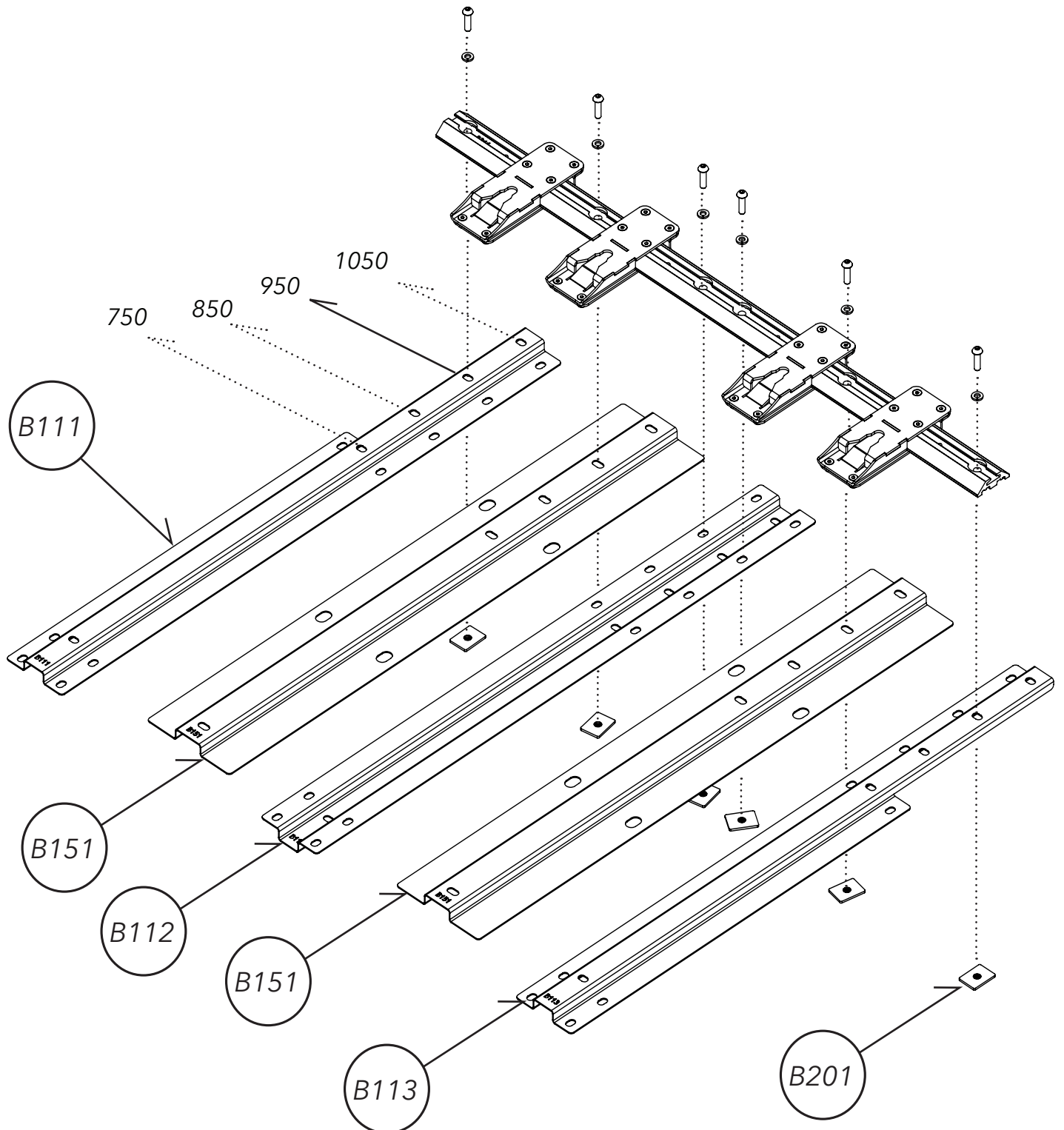

STEP 9 - Partial Assembly of the Mounting Platform Frame:

- Use M8 x 25 Button Head bolts and M8 Spring Washer passing through the Rails to each Bracket. Place the B201 M8 Channel Nut, flat side up toward the bracket.
- Secure the Rail with Catch Brackets into the corresponding hole positions for the Drawer depth you are planning to install: 750, 850, 950 or 1050 Drawer Sizes.
- Loosely secure the parts to allow for alignment adjustments.

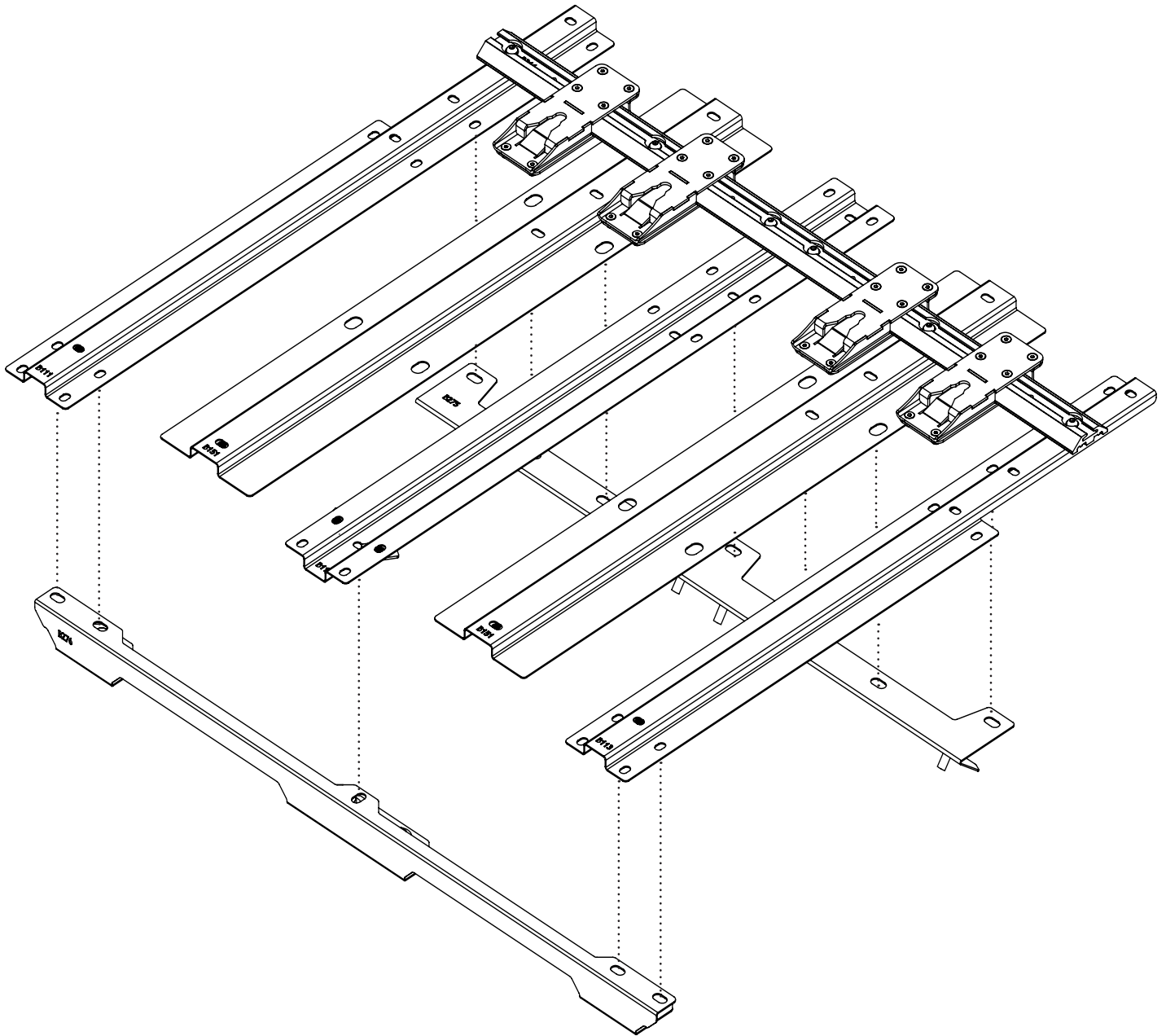

STEP 10 - Alignment of Mounting Platform to the Vehicle Floor Brackets

- Align the partial assembly of the Mounting Platform to the Vehicle Floor Brackets

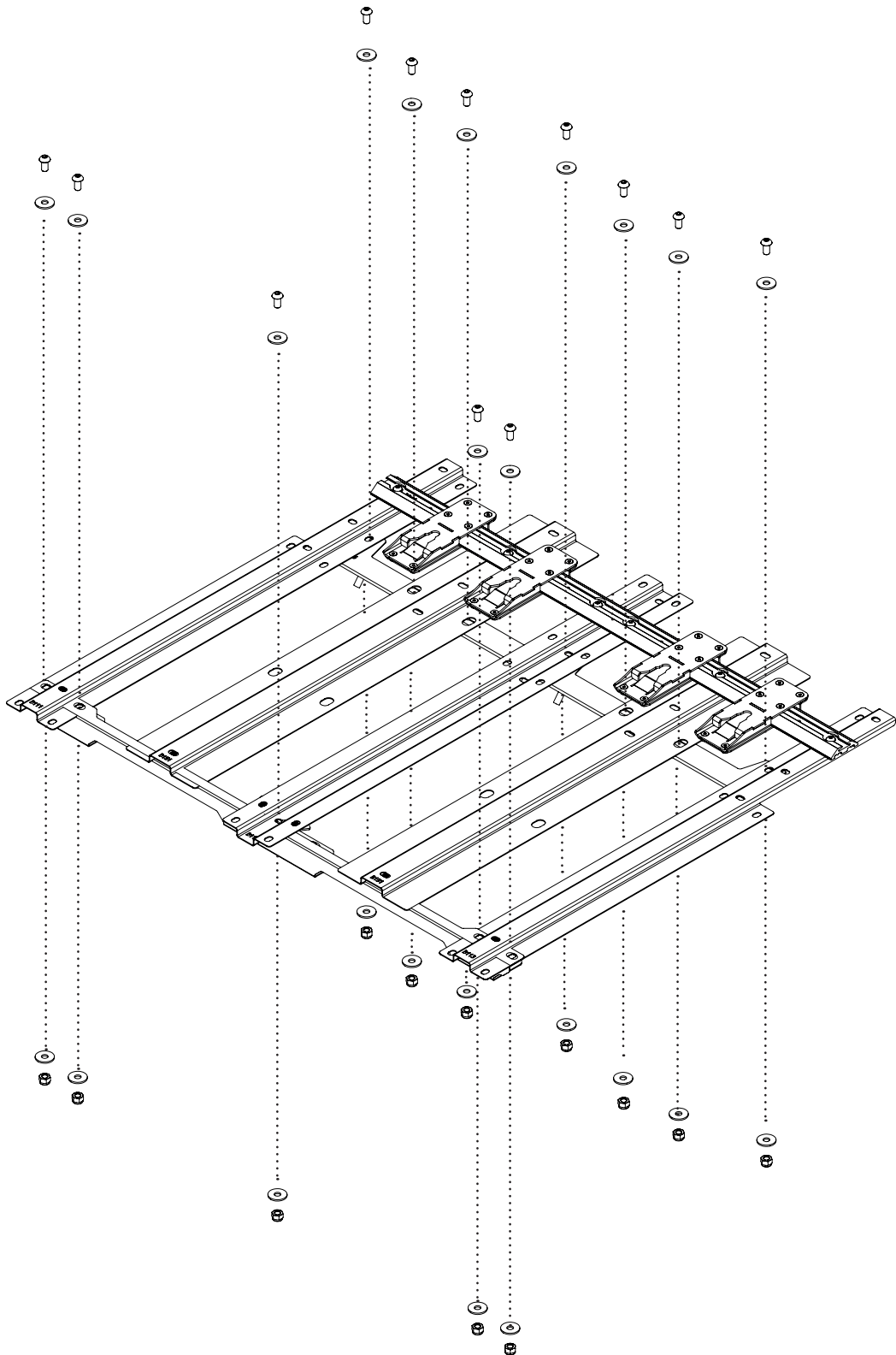

STEP 11 - Assembly of Mounting Platform to Vehicle Floor Brackets

- Use fasteners M8 x 25mm Button head bolts AND Large Washer to attach the partial assembly of the Mounting Platform to the Vehicle Floor Brackets. Use large washers and M8 Lock Nut on the underside of the Floor Brackets.
- Do not tighten fasteners.

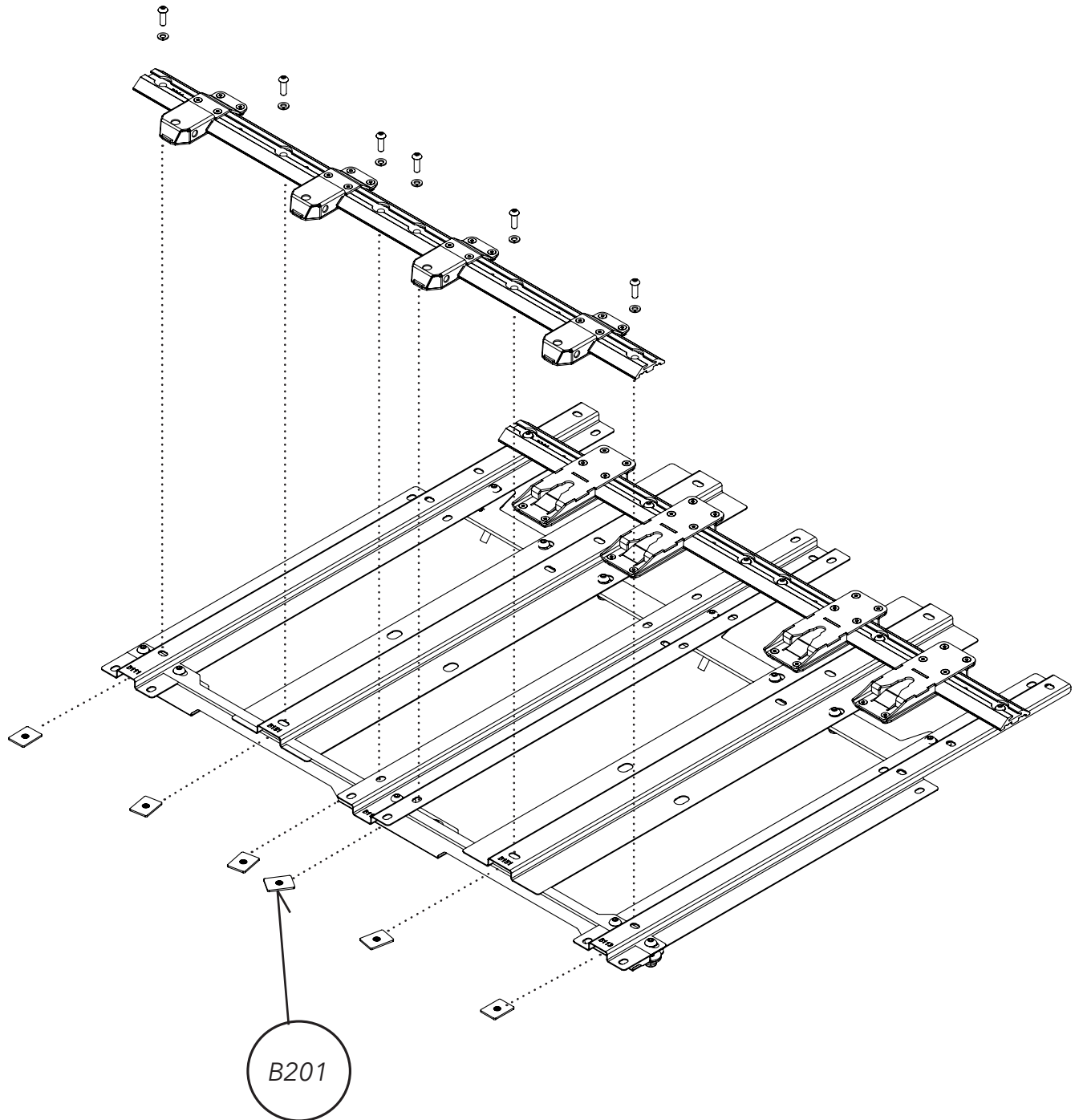

STEP 12 - Mounting Platform Assembly, Continued...

- Use fasteners M8 x25mm Button Head Bolt AND M8 Spring Washer to attach the partial assembly of the Mounting Platform to the Vehicle Floor Brackets.
- Use the B201 M8 Channel Nut under the Mounting Platform brackets
- Slide the B201 M8 Channel Nut into the channels, with the flat side facing up.
- Do not tighten fasteners.

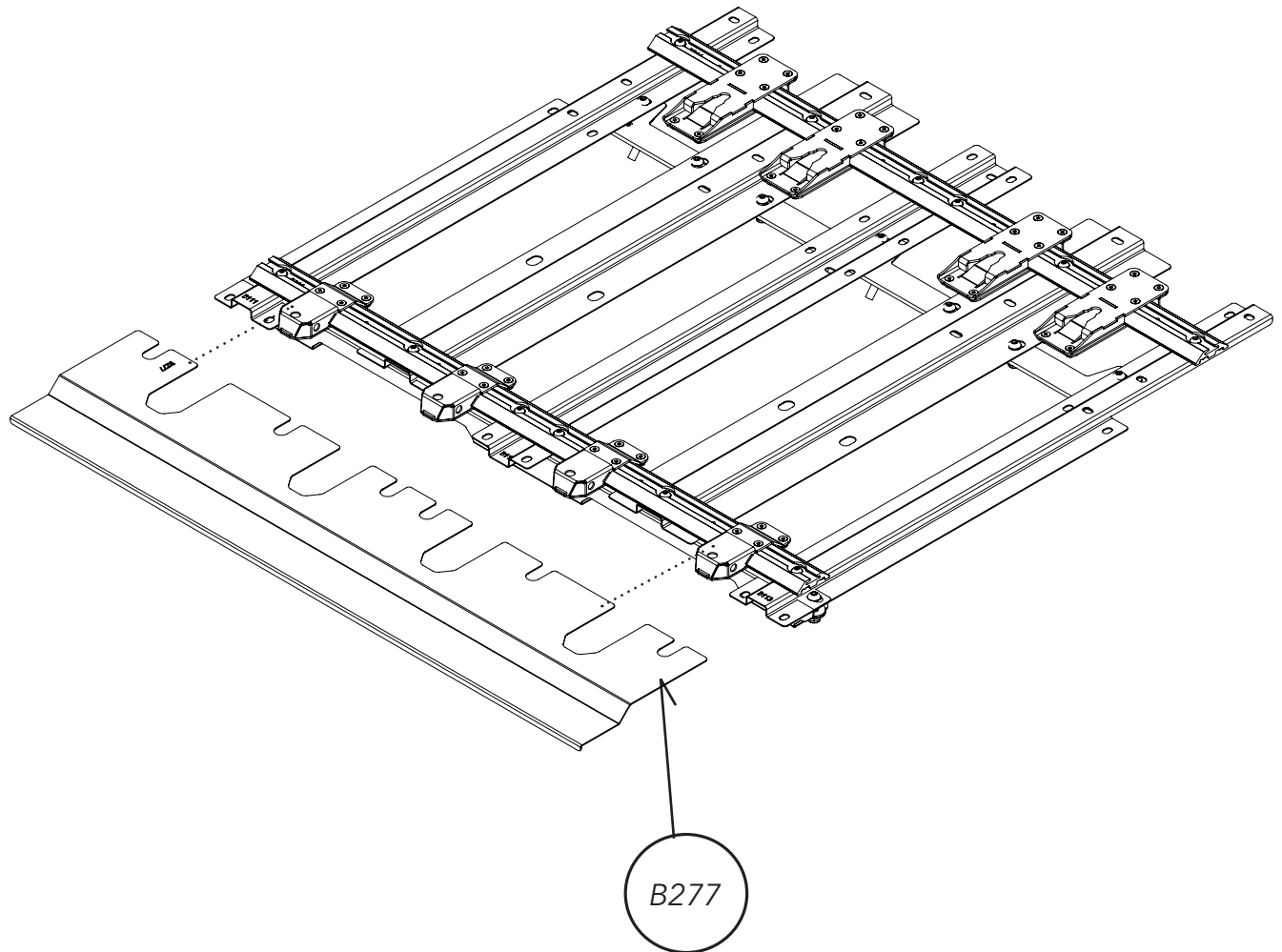

STEP 14 - Trim Assembly

- The Front Rail B311 with Click Brackets pre-assembled should be loose enough to slide the Full Trim B277 underneath.
- Align the cut outs to the Click Brackets. Loosen to ensure the Trim fits all the way in to position.
- NOTE: Check that both Front and Rear Rails are parallel, and check that the installation is flat, without any warping.
- Securely tighten all fasteners, using hand tools only.
- Recheck that the installation is flat and the Front and Rear Rails are aligned.

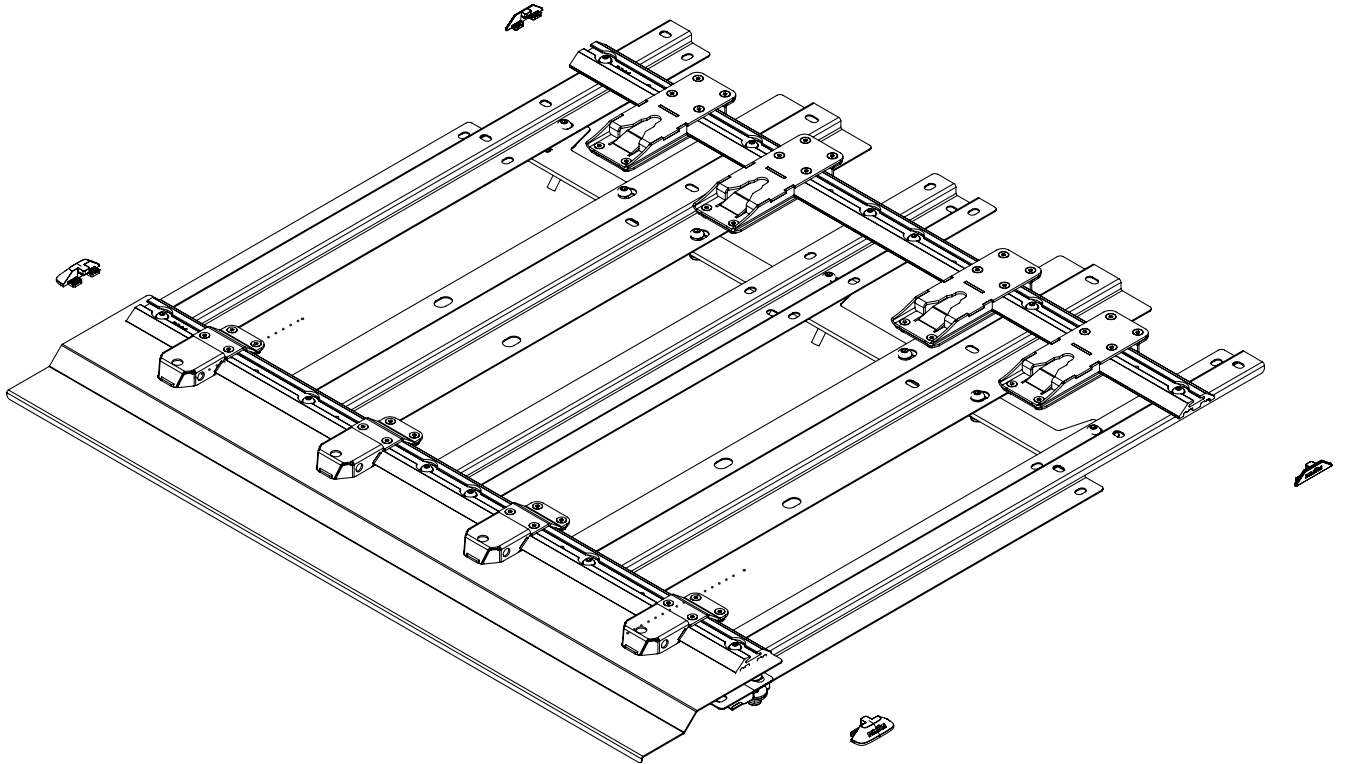

STEP 14 - End Caps

- Assemble the End Caps B402 and B403 into the ends of Front and Rear Rails.



KUFU Drawer System

Designed and Developed in Australia

Impact Import Group Pty. Ltd
153 Ash Road
Leopold, VIC 3224